



synthesi
steel

PUSH BUTTON PANEL

Download from www.urmet.com Technical Manuals area.

SECTION CONTENTS

CAMERA MODULE AND DOOR UNIT WITH 2 BUTTONS	
Ref. 1083/62	2
Features	2
Structure	2
Terminal pins description	2
Technical characteristics	3
Default programming	3
Operating	3
Audio adjustment	3
Name holders lighting	4
DOOR UNIT MODULE WITH 2 BUTTONS Ref.1083/6	4
Features	4
Structure	4
Terminal pins description	4
Technical characteristics	5
Default programming	5
Operating	5
Audio adjustment	5
Name holders lighting	5
1-BUTTON FRONT UNIT	6
Assigning code 0 to the button	6
Factory codes restore	6
16-USER EXPANSION MODULE Ref. 1083/17	7
Connection example	7
Technical characteristics	7
PRODUCT LISTS	8
INSTALLATION	8
DIMENSIONS	10
VIDEO DOOR PHONE SYSTEMS	
Modularity examples for different system dimensions	11
DOOR PHONE SYSTEMS	
Modularity examples for different system dimensions	15
CONFIGURATION	19
ASSOCIATION OF DOOR UNITS BUTTONS TO USERS	20
Main door units	20
Secondary door units	21
OPTIONAL PROGRAMMING	22
Auto-on function on surveillance cameras	22
Button configuration for special function	22
PROGRAMMING DATA DELETING	22



SINTHESI STEEL PUSH BUTTON PANEL

CAMERA MODULE AND DOOR UNIT WITH 2 BUTTONS

urmet

SINTHESI STEEL PUSH BUTTON PANEL

Sinthesi Steel is a vandal resistant push button panel made of steel, suitable for harsh environment.

Sinthesi Steel is the evolution of Sinthesi push button panel, with the same modular structure. For this reason, with a reduced number of components and shelf items cards it is possible to realize any types and configurations of push button panels.

The product range continuity is guaranteed by the possibility to use Sinthesi Steel devices when the existing flush mount box is the one used for Sinthesi or K-Steel push button panels.

Special care has been dedicated to new modules, optimized to make installation quicker by using pre-cabled wires with connectors, implementing new modules as DDA (Disability Discrimination Act) used to know system operation and ILA (Induction loop Antenna) modules, that allow hard of hearing people provided with hearing aid with T operating mode, to hear the door phone conversation.

CAMERA MODULE AND DOOR UNIT WITH 2 BUTTONS Ref. 1083/62

FEATURES

- Installation on Sinthesi Steel module holder frames with 2 modules.
- Two pre-wired call buttons.
- 4 expansion modules (connected in series) can be connected, up to 64 user buttons max. for each door unit.
- Connection of 16-user expansion module Ref. 1083/17 with connector.
- Up to 4 main call stations and up to two secondary call stations can be connected for each column.
- Fixed focus colour camera with embedded lens and shutter.
- Embedded illuminator, that can be excluded under sufficient lighting conditions.
- Codes sequences can be assigned to call buttons with dip-switch.
- All the programming procedure can be performed with dip-switch.
- Off-hook waiting time: 60 seconds (system busy).
- The guaranteed communication time can be programmed with rotary-switch up to 70 seconds (system busy).
- Max. conversation time starting when the handset is picked up: 10 minutes.
- Tone for confirming call sending and conversation end.
- Video-audio signals of system busy.
- Pedestrian electric lock command actuator. Programmable timing with rotary-switch from 1 to 90 seconds.
- Driveway electric lock command actuator with clean contact.
- Electric lock management: Free or Secret.
- Circuitry for electric lock activation with entrance hall button.
- Input for open door sensor.
- Trimmer for adjusting loudspeaker and microphone audio level.
- Management of two external coax video inputs for surveillance cameras, if present.
- Relay box driving for cyclic control of several video surveillance cameras.
- Output for power supply of name holders lighting (up to 32 buttons with the power supply unit Ref. 1083/20).
- Audio repeater device for hard of hearing people.
- Designed for DDA module with voice messages and led connection.

STRUCTURE

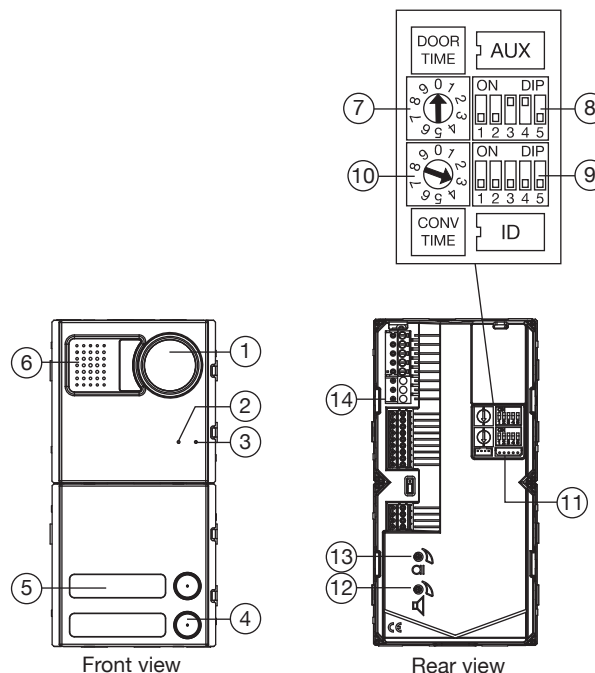

1. Camera
2. Signalling yellow led
3. Microphone
4. Pre-wired buttons
5. Name holders
6. Loudspeaker
7. Rotary-switch for pedestrian door lock release activation time
8. Auxiliary settings dip-switch
9. Identification code dip-switch
10. Busy time rotary-switch
11. Connector for expansion module
12. Loudspeaker volume adjustment
13. Microphone volume adjustment
14. Terminal blocks

TERMINAL PINS DESCRIPTION

⊗	LINE	Incoming Bus line
⊗	SE+	Positive for pedestrian electric lock activation
⊗	SE-	Negative for pedestrian electric lock activation
⊗	A [V3	Surveillance camera 1 signal
⊗	V5	Reference for surveillance camera 1 signal
⊗	B [V3	Surveillance camera 2 signal / video switch
⊗	V5	Reference for surveillance camera 2 / video switch
⊗	ILA	Hard of hearing device output
⊗	SE2	Driveway electric lock activation
⊗	T+	Command for video switch
⊗	T-	Reference for video switch
⊗	CT	Reference for PA and SP
⊗	PA	Entrance hall button
⊗	SP	Open door sensor (*)
⊗	ILL	Power supply for name holders lighting
⊗	-	} Do not use
⊗	+	

EXP Connector for expansion module Ref. 1083/17

I2C Connector for module with voice messages and led Ref. 1158/47

(*) the terminal pin SP is connected by default to the terminal pin CT; to connect the normally close door sensor (with closed door), remove the jumper.



TECHNICAL CHARACTERISTICS

Power supply voltage (LINE): **36 - 48 Vdc**
 Standby current consumption: **45 mA max**
 Max. current consumption: **250 mA max**
 (video call and name holders on)
 Name holders lighting ILL output: **11 - 13,8 Vdc max 200 mA**
 Lock output SE+ and SE-: **22 - 24 Vdc max 200 mA**
 SE2 switched load: **300 mA 125 V Max**
 Operating temperature range: **-10 ÷ 50°C**
 Compliant with: **EN 61000-6-3, EN 61000-6-1**

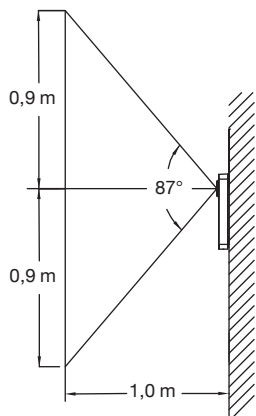

Vertical field of view

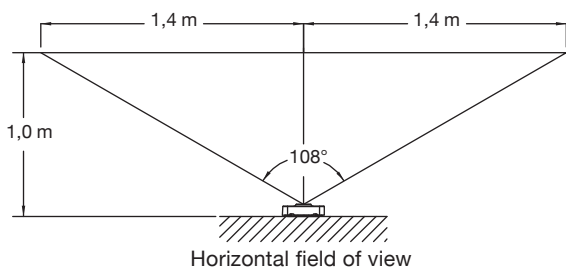

Horizontal field of view

DEFAULT PROGRAMMING

All cameras are configured in factory as follows:

Call station type: **main**
 Secondary number: **0**
 Door lock release: **free**
 Interruption: **Not enable**
 Camera illuminators: **on**
 Guaranteed communication time rotary: **30 s (pos 3)**
 Door lock release rotary: **1 s (pos 0)**
 Door unit number: **0**
 Power supply: **from the line (LINE)**

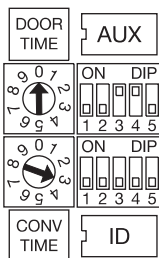

OPERATION

CALLS

Up to 64 users max. can be called by pressing the respective buttons of the push button panel associated to the camera Ref. 1083/72.

After pressing the call button, the two following cases can occur:

- The line is free: the door unit emits a confirmation tone and the call is sent to the selected user.
- The line is busy: the door unit emits an alert tone and the yellow led on the front blinks (when the busy time is elapsed, the call must be sent again).



If in the system there is a concierge switchboard in "Day" mode, all the calls performed from the main call stations are intercepted and managed by the switchboard.

PEDESTRIAN ELECTRIC LOCK ACTIVATION

Door units are provided with two terminal pins for pedestrian electric lock activation (SE-, SE+). The electric lock is activated in the following cases:

- Each time the entrance hall button is pressed (terminal pins PA, CT).
- After receiving a door lock release command from an apartment station, according to the configuration of the dip-switch used to configure the operating mode "free" or "secret" (see section "2VOICE system", paragraph "Call stations features").
- When the call is sent to an apartment station which is provided with "automatic door lock release" feature and this function is active.

If electric locks to be activated need special timing, the rotary switch "DOOR TIME" must be adjusted.



During electric lock activation, additional name holders, if powered by door unit terminal pins ILL, switch off.

DRIVEWAY DOOR LOCK RELEASE MANAGEMENT

Door units are provided with two terminal pins (SE2) connected to the contacts of a normally open relay, that can be used to command a gate opening control panel. The relay is activated for 1 sec. after receiving a driveway door lock release command from an apartment station, according to the configured operation mode, "free" or "secret", as for the pedestrian electric lock.



This relay is NOT suitable to manage directly power loads, but can only be used as command relay.

AUDIO ADJUSTMENT

Audio levels are trimmed in factory, so they don't need to be changed in most installations.

If it is necessary to change them, use a screwdriver on the suitable adjusting points.

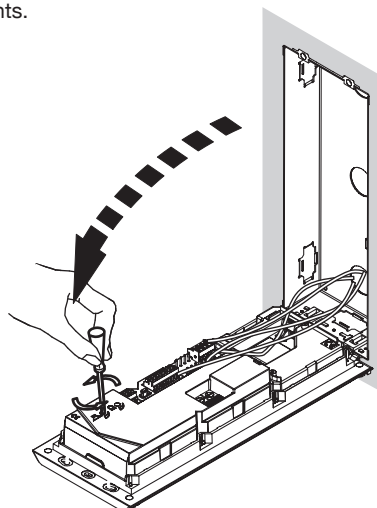



SINTHESI STEEL PUSH BUTTON PANEL

DOOR UNIT MODULE WITH 2 BUTTONS

urmet

NAME HOLDERS LIGHTING

If the call station has more than 32 name holders, an additional transformer must be used for button modules lighting. In this case, the terminal pins "ILL" of the call station must not be connected to the button modules.

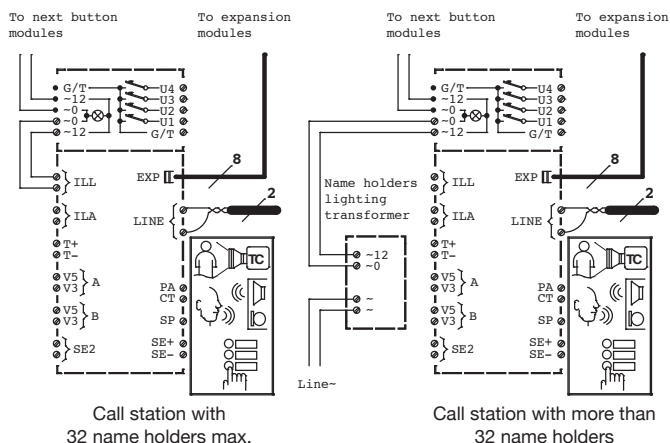

The transformer Ref. 9000/230 can provide 11,2 W power, that is up to 64 name holders max.

The number of name holders could be reduced according to distance and section of the used cable.

DOOR UNIT MODULE WITH 2 BUTTONS Ref.1083/6

FEATURES

- Installation on 2-module Sinthesi Steel module holder frames.
- Two pre-wired call buttons.
- 4 expansion modules can be installed (connected in series), up to 64 user buttons max. for each door unit.
- Connection of 16-user expansion module Ref. 1083/17 with connector.
- Up to 4 main call stations and up to 2 secondary call stations can be connected for each column.
- Code sequences can be assigned to call buttons with the dip-switch.
- All the programming procedure can be performed with dip-switch.
- Off-hook waiting time: 60 seconds (system busy).
- Guaranteed communication time can be programmed with rotary-switch up to 70 seconds (system busy).
- Max. conversation time starting when the handset is picked up: 10 minutes.
- Tone for confirming call sending and conversation end.
- Video-audio signals of system busy.
- Pedestrian electric lock command actuator. Programmable timing with rotary-switch from 1 to 90 seconds.
- Driveway electric lock command actuator with clean contact.
- Electric lock management: Free or Secret.
- Circuitry for electric lock activation with entrance hall button.
- Input for open door sensor.
- Trimmer for adjusting loudspeaker and microphone audio level.
- Output for power supply of name holders lighting (up to 32 buttons with the power supply unit Ref. 1083/20).
- Audio repeater device for hard of hearing people.
- Designed for DDA module with voice messages and led connection.

STRUCTURE

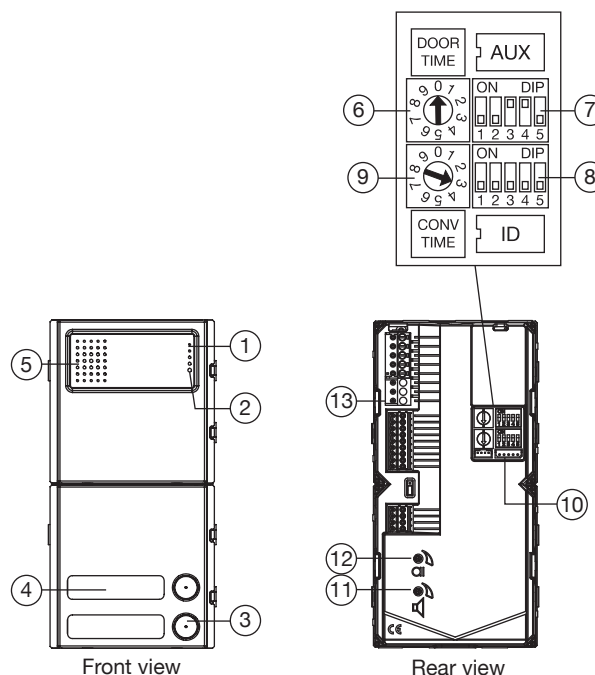

1. Signalling yellow led
2. Microphone
3. Pre-wired buttons
4. Name holders
5. Loudspeaker
6. Rotary-switch for pedestrian door lock release activation time
7. Auxiliary settings dip-switch
8. Identification code dip-switch
9. Busy time rotary-switch
10. Connector for expansion module
11. Loudspeaker volume adjustment
12. Microphone volume adjustment
13. Terminal blocks

TERMINAL PINS DESCRIPTION

-] LINE Incoming Bus line
- SE+ Positive for pedestrian electric lock activation
- SE- Negative for pedestrian electric lock activation
-] ILA Hard of hearing device output
-] SE2 Driveway electric lock activation
- CT Reference for PA and SP
- PA Entrance hall button
- SP Open door sensor (*)
-] ILL Power supply for name holders lighting
- - } Do not use
- + }

EXP Connector for expansion module Ref. 1083/17
I2C Connector for module with voice messages and led Ref. 1158/47

(*) the terminal pin SP is connected by default to the terminal pin CT; to connect the normally close door sensor (with closed door), remove the jumper.



TECHNICAL CHARACTERISTICS

Power supply voltage (LINE): **36 - 48 Vdc**
 Standby current consumption: **45 mA max**
 Max. current consumption: **220 mA max**
 (call and name holders on)
 Name holders lighting ILL output: **11 - 13,8 Vdc max 200 mA**
 Lock output SE+ and SE-: **22 - 24 Vdc max 200 mA**
 SE2 switched load: **300 mA 125 V Max**
 Operating temperature range: **-10 ÷ 50°C**
 Compliant with: **EN 61000-6-3, EN 61000-6-1**

DEFAULT PROGRAMMING

All door unit modules are configured in factory as follows:

Call station type: **main**
 Secondary number: **0**
 Door lock release: **free**
 Interruption: **Not enable**
 Camera illuminators: **on**
 Guaranteed communication time rotary: **30 s (pos 3)**
 Door lock release rotary: **1 s (pos 0)**
 Door unit number: **0**
 Power supply: **from the line (LINE)**

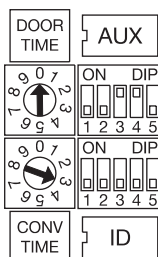

OPERATION

CALLS

Up to 64 users max. can be called by pressing the respective buttons of the push button panel associated to the door unit.

After pressing the call button, the two following cases can occur:

- The line is free: the door unit emits a confirmation tone and the call is sent to the selected user.
- The line is busy: the door unit emits an alert tone and the yellow led on the front blinks (when the busy time is elapsed, the call must be sent again).

If in the system there is a concierge switchboard in "Day" mode, all the calls performed from the main call stations are intercepted and managed by the switchboard.

PEDESTRIAN ELECTRIC LOCK ACTIVATION

Door units are provided with two terminal pins for pedestrian electric lock activation (SE-, SE+). The electric lock is activated in the following cases:

- Each time the entrance hall button is pressed (terminal pins PA, CT).
- After receiving a door lock release command from an apartment station, according to the configuration of the dip-switch used to configure the operating mode "free" or "secret" (see section "2VOICE system", paragraph "Call stations features").
- When the call is sent to an apartment station which is provided with "automatic door lock release" feature and this function is active.

If electric locks to be activated need special timing, the rotary switch "DOOR TIME" must be adjusted.

During electric lock activation, additional name holders, if powered by door unit terminal pins ILL, switch off.

DRIVEWAY DOOR LOCK RELEASE MANAGEMENT

Door units are provided with two terminal pins (SE2) connected to the contacts of a normally open relay, that can be used to command a gate opening control panel. The relay is activated for 1 sec. after receiving a driveway door lock release command from an apartment station, according to the configured operation mode, "free" or "secret", as for the pedestrian electric lock.

This relay is NOT suitable to manage directly power loads, but can only be used as command relay.

AUDIO ADJUSTMENT

Audio levels are trimmed in factory, so they don't need to be changed in most installations.

If it is necessary to change them, use a screwdriver on the suitable adjusting points.

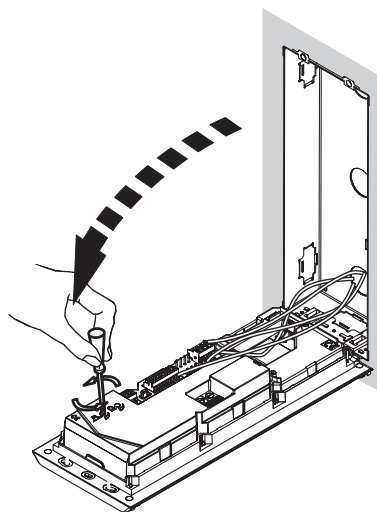

NAME HOLDERS LIGHTING

If the call station has more than 32 name holders, an additional transformer must be used for button modules lighting.

In this case, the terminal pins "ILL" of the call station must not be connected to the button modules.

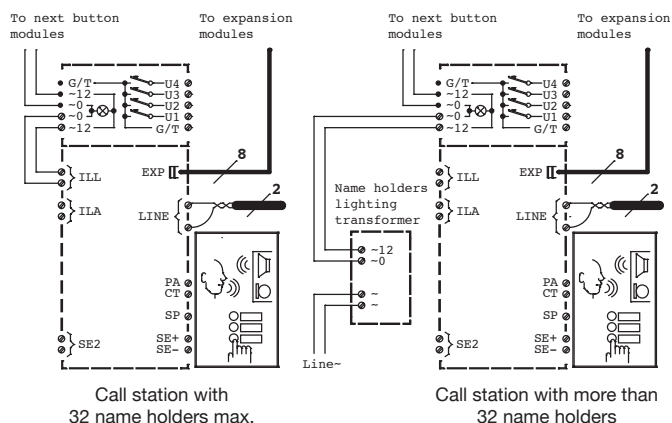

The transformer Ref. 9000/230 can provide 11,2 W power, that is up to 64 name holders max.

The number of name holders could be reduced according to distance and section of the used cable.



SINTHESI STEEL PUSH BUTTON PANEL

1-BUTTON FRONT UNIT



1-BUTTON FRONT UNIT

For call station with 1 button, the front unit Ref. 1758/107 must be bought and installed as follows:

Installation modes are the same as for modules with camera and door unit modules.

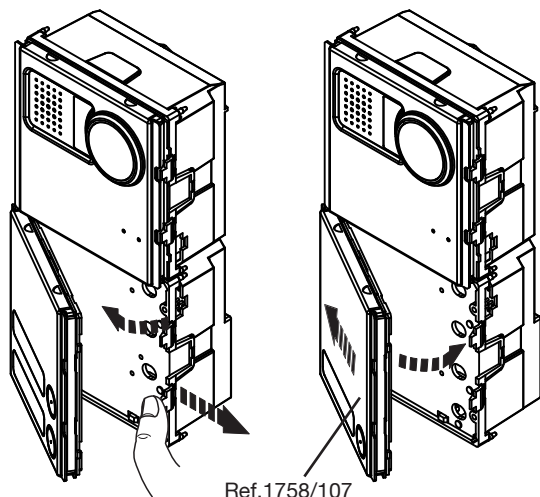

Ref.1758/107

In this case, if the button is pressed, the apartment station with user code CODE=1 will be called.
If the module is provided with firmware version 3.1 or higher, perform the following programming procedure to call the apartment station with code 0.

ASSIGNING CODE 0 TO THE BUTTON

1. Enter in programming mode by setting the rotary switch DOOR TIME to position 8 and the rotary switch CONV TIME to position 9. The call station will emit 2 beeps each second to indicate the programming state.



2. Press the call station button. The module will emit a long beep to indicate that programming has been successful.

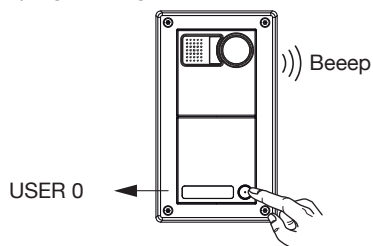

3. Restore the rotary switches original position to exit from the programming mode.

FACTORY CODES RESTORE

To restore the user code assigned to the button, follow the procedure below:

1. Enter in programming mode by setting the rotary switch DOOR TIME to position 8 and the rotary switch CONV TIME to position 9. The call station will emit 2 beeps each second to indicate the programming state.

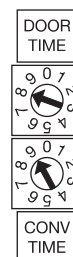

2. Press the button in the upper side of the call station. The module will emit a long beep to indicate that programming has been successful.

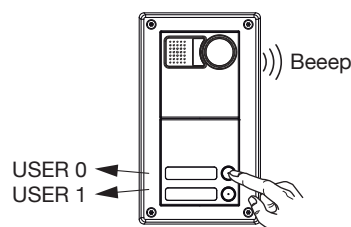

3. Set the rotary switches to the correct position to exit from the programming mode.



16-USER EXPANSION MODULE Ref. 1083/17

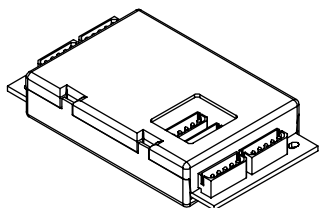

The expansion module allows to add 16 user buttons to the door unit.

Place the device in the push button panel as shown in the following figures.

Connect the user buttons and connect the device to the door unit or to other expansion modules, if present, with the suitable cable, respecting connection direction and passages in flush mounting boxes.

INSTALLATION ON MODULES WITH 3 AND 4 BUTTONS

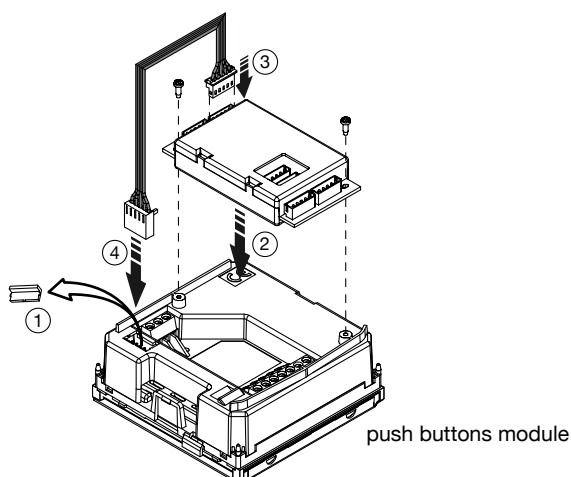

INSTALLATION ON MODULES WITH 1 AND 2 BUTTONS

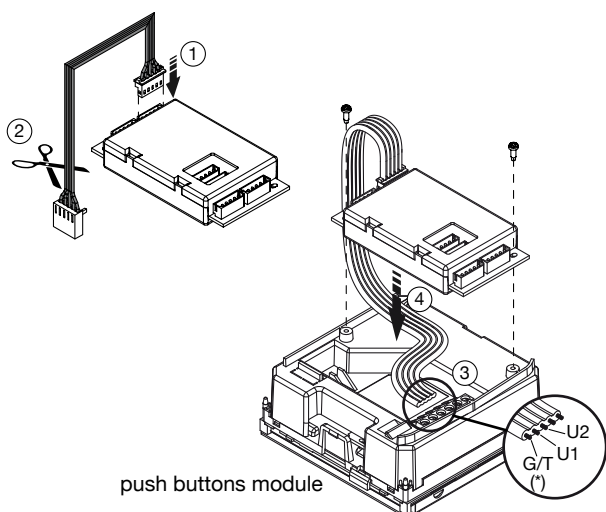

(*) red

CONNECTION EXAMPLE

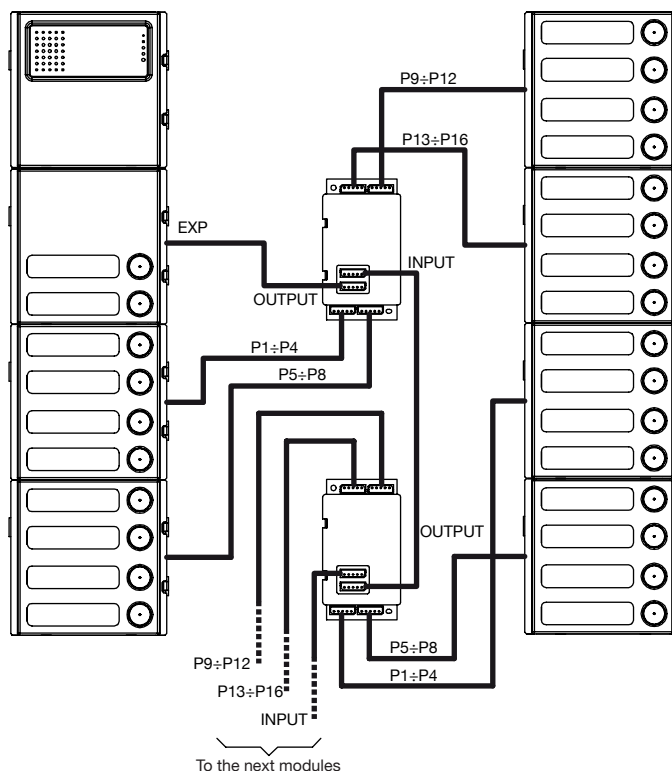

TECHNICAL CHARACTERISTICS

Current consumption: 1mA Max
 Current in user button: ~1mA
 Operating temperature range: +0 ÷ +50°C
 Humidity: 90% UR a 30 °C



SINTHESI STEEL PUSH BUTTON PANEL

PRODUCT LISTS - INSTALLATION

urmet

PRODUCT LISTS

All Sinthesi Steel products, their characteristics and installation modes are described in "Products Technical Manual - Door Phone and Video Door Phone system" in the section "Sinthesi Steel Push Button Panel"

BUTTONS MODULES

With 1 button	Ref. 1158/11
With 2 buttons	Ref. 1158/12
With 3 buttons	Ref. 1158/13
With 4 buttons	Ref. 1158/14

SPECIAL MODULES

Directory module	Ref. 1158/50
Blind module	Ref. 1158/59
DDA module with voice messages.....	Ref. 1158/47
Hearing impaired people module.....	Ref. 1158/48

FLUSH MOUNTING BOXES

For 2 modules	Ref. 1158/42
For 3 modules	Ref. 1158/43
For 4 modules	Ref. 1158/44

FRAMES AND MODULE HOLDERS

For 2 modules	Ref. 1158/62
For 3 modules	Ref. 1158/63
For 4 modules	Ref. 1158/64

RAIN HOODS

For 2 modules	Ref. 1158/612
For 3 modules	Ref. 1158/613
For 4 modules	Ref. 1158/614
For 4 modules (2 module holders with 2 modules)	Ref. 1158/624
For 6 modules (2 module holders with 3 modules)	Ref. 1158/626

HOODED HOUSINGS

For 2 modules	Ref. 1145/312
For 2 modules	Ref. 1145/313
For 2 modules	Ref. 1145/314

INSTALLATION

It is suggested to install the modules at the height shown below, according to the system to be realized.

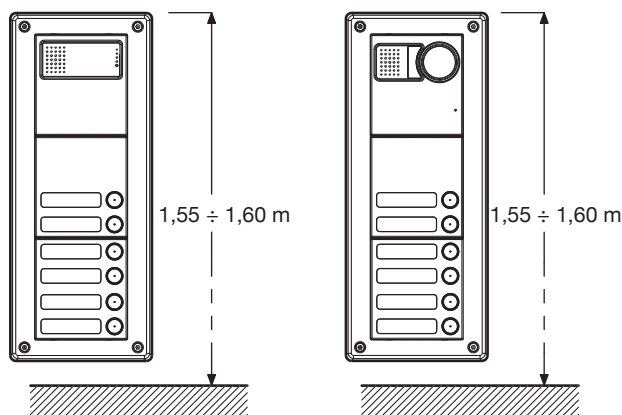

However, for complex systems with several modules, for a correct installation consider the height shown in the figure to fix the camera. If the system is a door phone, height refers to the door unit.

- Before installing the flush mounting box (single or coupled with other ones), prepare the hole (at the bottom or at the sides) for the passage of connection wires.

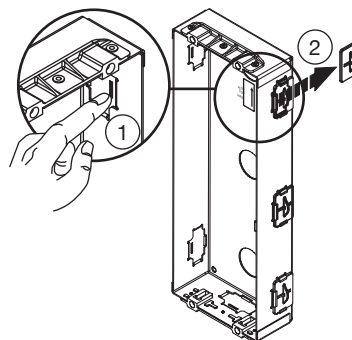

- Fit the flush mounting box in line with the wall: it must not project.

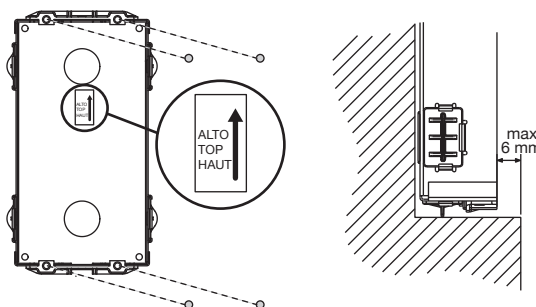

- Apply the adhesive labels on the frame screw holes before installing the box.

- Fit the module holder frame.

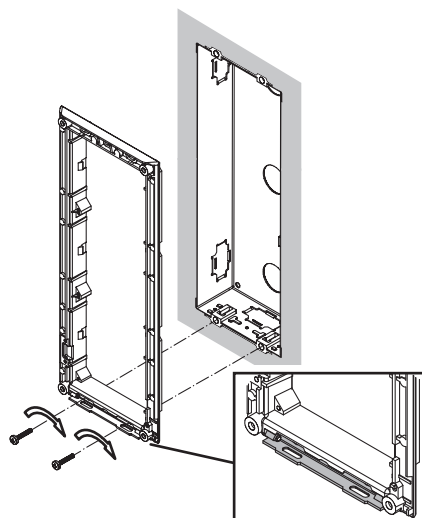

- Fit the modules in the frame.



- Turn the frame round, connect wires and set the dip-switches.

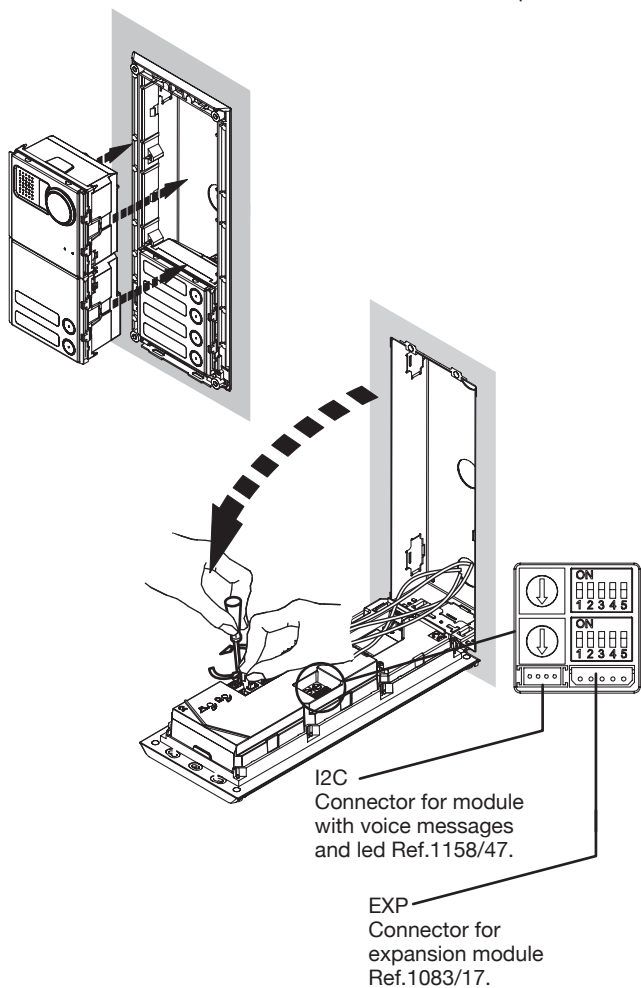

- Close the module holder.
- Adjust correct perpendicularity of the panel.

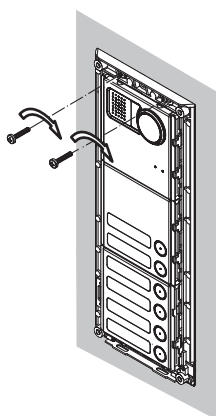

- Fit the name tags.

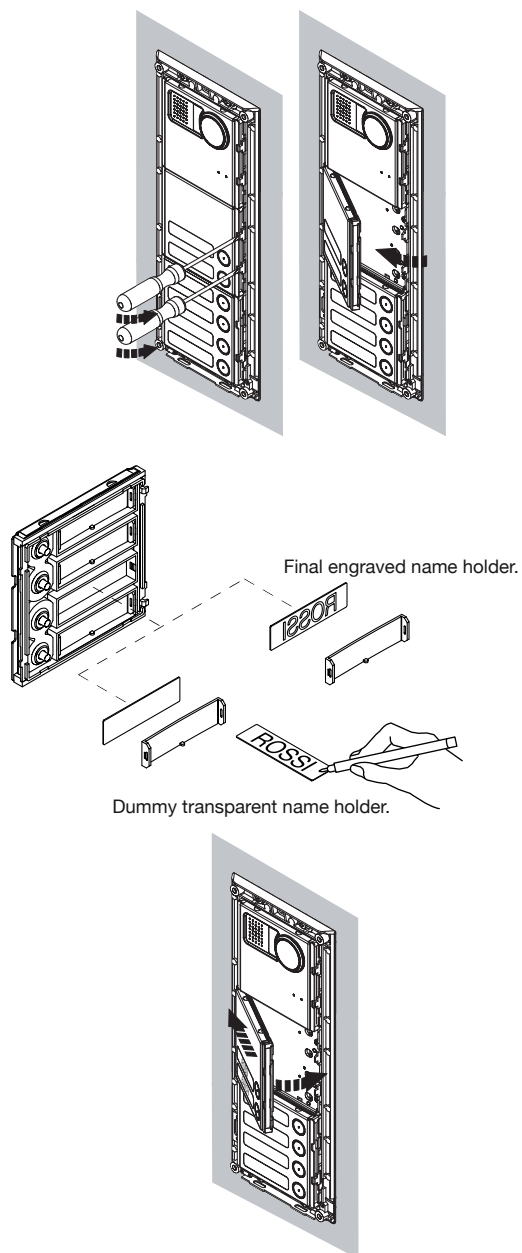

- Fit the panel on the frame.

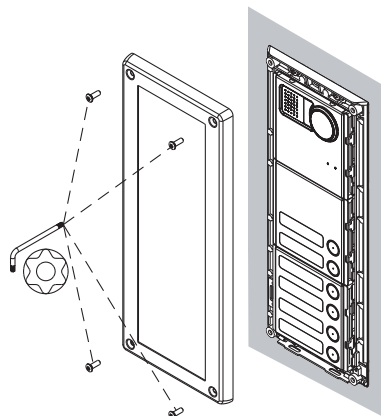



SINTHESI STEEL PUSH BUTTON PANEL

DIMENSIONS



FLUSH-MOUNTED VERSION

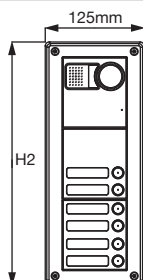
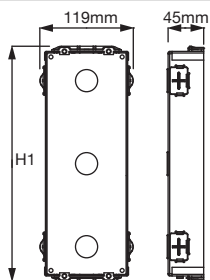

	H1	H2
For 1 module	117 mm	127 mm
For 2 modules	207 mm	217 mm
For 3 modules	297 mm	307 mm
For 4 modules	387 mm	397 mm

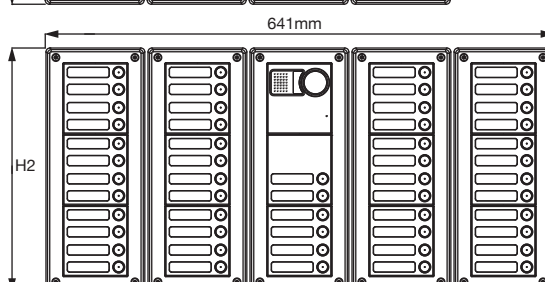
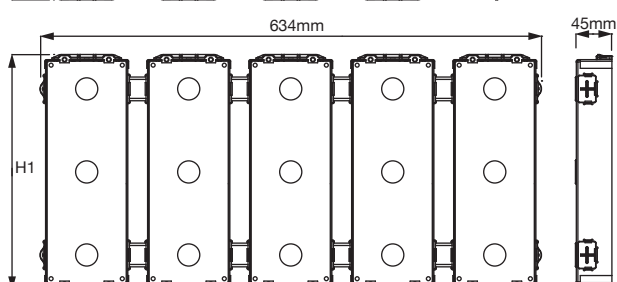
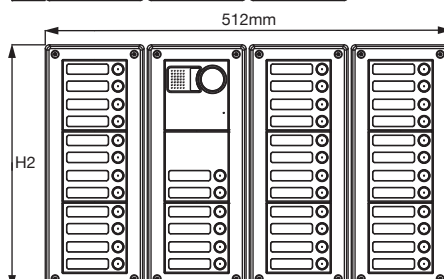
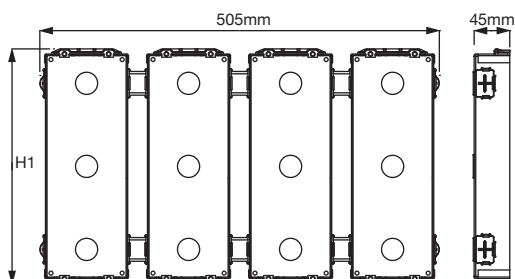
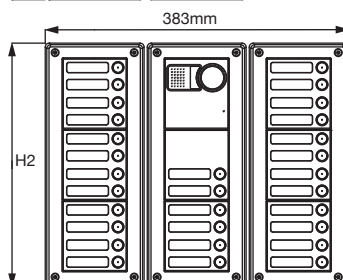
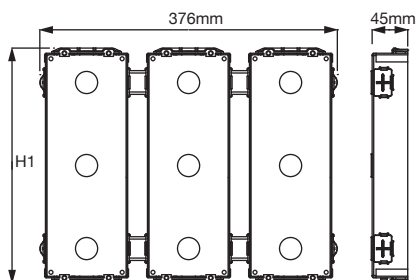
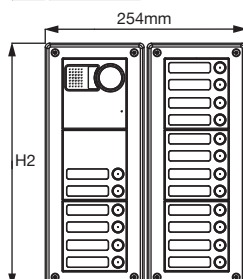
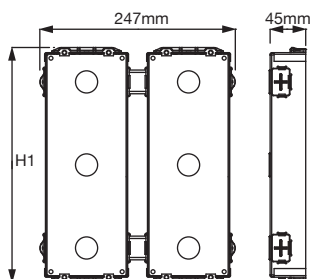

WALL-MOUNTED VERSION

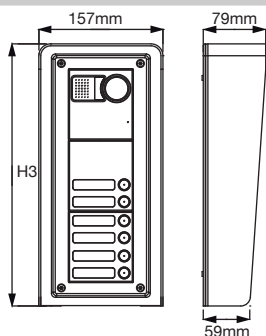

	H3
For 1 module	151,5 mm
For 2 modules	241,5 mm
For 3 modules	331,5 mm
For 4 modules	421,5 mm



		BUTTONS NUMBER																														
		1	2	3	4	5	6	7	7h	8	8 _h	9	9 _h	10	10 _h	11	12	13	14	15	16	17	18	19	20	21	22	23	24	25	26	27
Button modules	1158/11			1				1	1							1				1				1				1				1
	1158/12				1					1	1						1				1				1				1			
	1158/13					1						1	1					1				1				1				1		
	1158/14						1	1	1	1	1	1	1	2	2	2	2	2	3	3	3	3	4	4	4	4	5	5	5	5	6	6
Special modules	1158/50															1	1	1	1													
Camera modules with door unit	1083/62	1	1	1	1	1	1	1	1	1	1	1	1	1	1	1	1	1	1	1	1	1	1	1	1	1	1	1	1	1	1	1
Frontalino con 1 tasto	1758/107	1																														
Expansion module	1083/17			1	1	1	1	1	1	1	1	1	1	1	1	1	1	1	1	1	1	1	1	2	2	2	2	2	2	2	2	2
Flush mounting box	1158/42	1	1						2		2		2		2																	
	1158/43			1	1	1	1									2	2	2	2	2	2	2	2									3
	1158/44							1		1		1		1										2	2	2	2	2	2	2	2	2
Module holders and frames	1158/62	1	1						2		2		2		2																	
	1158/63			1	1	1	1									2	2	2	2	2	2	2	2									3
	1158/64							1		1		1		1										2	2	2	2	2	2	2	2	2
Rain hood	1158/612	1	1																													
	1158/613			1	1	1	1																									
	1158/614							1		1		1		1																		
	1158/624								1		1		1		1																	
	1158/626															1	1	1	1	1	1	1	1									
Case with hood (**)	1158/312	1	1																													
	1158/313			1	1	1	1																									
	1158/314							1		1		1		1																		

(**) Instead of products for flush mounting installatio: flush mount boxes, frames and module-holder frames and rain hoods.

		BUTTONS NUMBER																																	
		28	29	30	31	32	33	34	35	36	37	38	39	40	41	42	43	44	45	46	47	48	49	50	51	52	53	54	55	56	57	58			
Button modules	1158/11				1				1				1				1				1				1				1				1		
	1158/12	1				1				1				1				1				1					1					1			
	1158/13		1				1				1				1				1				1					1					1		
	1158/14	6	6	7	7	7	7	8	8	8	8	9	9	9	9	10	10	10	10	11	11	11	11	12	12	12	12	13	13	13	13	14			
Special modules	1158/50				1	1	1	1	1	1	1					1	1	1	1	1	1	1	1												
	1158/59				1	1	1	1								1	1	1	1																
Camera modules with door unit	1083/62	1	1	1	1	1	1	1	1	1	1	1	1	1	1	1	1	1	1	1	1	1	1	1	1	1	1	1	1	1	1	1	1		
Expansion module	1083/17	2	2	2	2	2	2	2	3	3	3	3	3	3	3	3	3	3	3	3	3	3	3	3	4	4	4	4	4	4	4	4	4		
Flush mounting box	1158/43	3	3	3													5	5	5	5	5	5	5	5	5	5	5	5							
	1158/44				3	3	3	3	3	3	3	3	3	3	3	3														4	4	4	4		
Module holders and frames	1158/63	3	3	3													5	5	5	5	5	5	5	5	5	5	5	5	5						
	1158/64				3	3	3	3	3	3	3	3	3	3	3	3														4	4	4	4		
Name holders lighting transformer	9000/230					1	1	1	1	1	1	1	1	1	1	1	1	1	1	1	1	1	1	1	1	1	1	1	1	1	1	1	1		



SINTHESI STEEL PUSH BUTTON PANEL

urmet

VIDEO DOOR PHONE SYSTEMS
MODULARITY EXAMPLES FOR DIFFERENT SYSTEM DIMENSIONS

SINTHESI STEEL PUSH BUTTON PANEL - VIDEO DOOR PHONE SYSTEMS

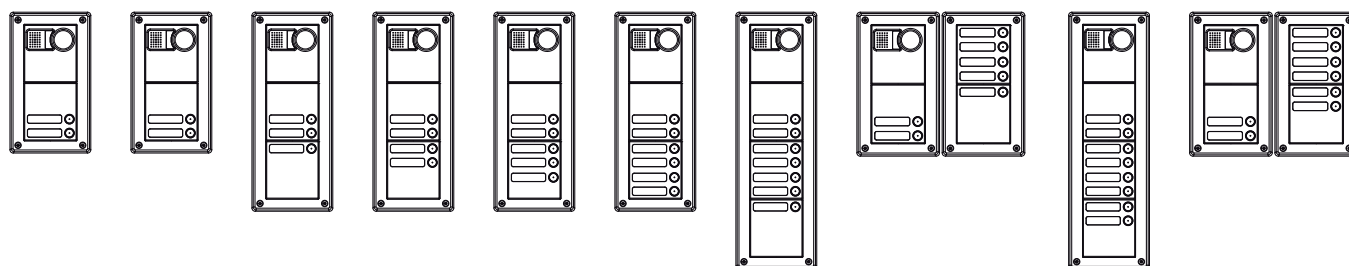

1 2 3 4 5 6 7 7_h 8 8_h

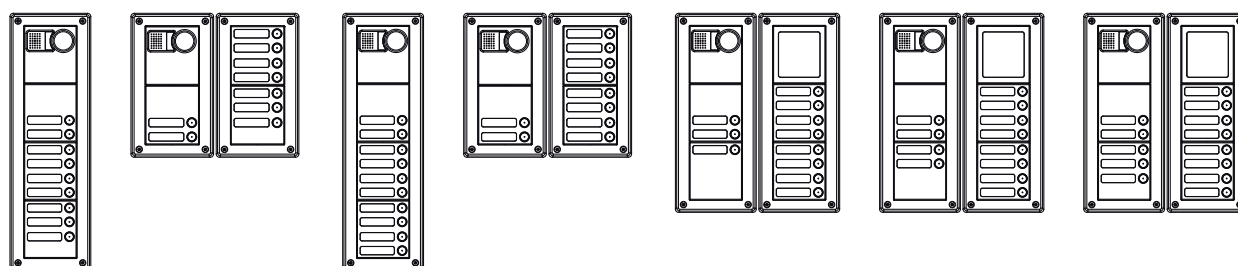

9 9_h 10 10_h 11 12 13

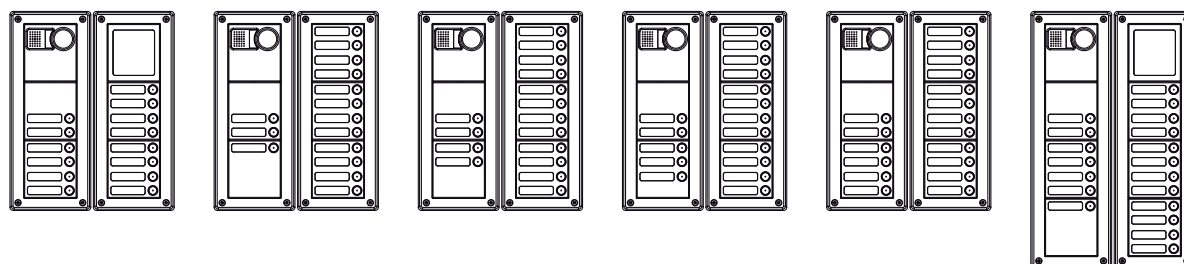

14 15 16 17 18 19

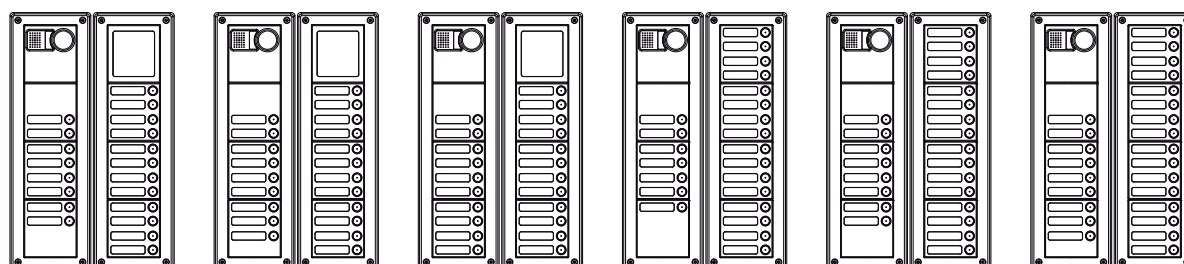

20 21 22 23 24 25

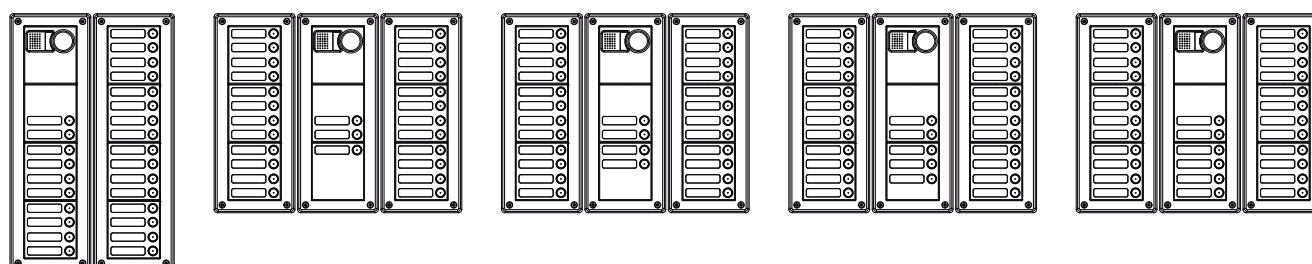

26 27 28 29 30

PUSH BUTTON PANEL

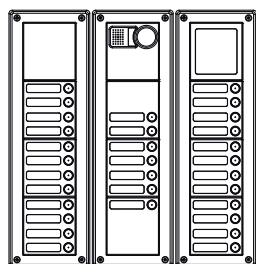

31

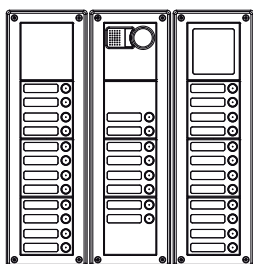

32

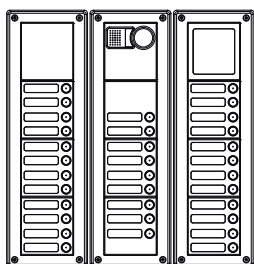

33

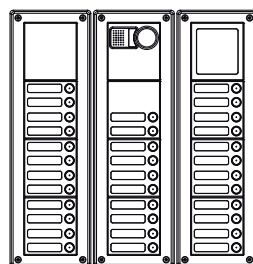

34

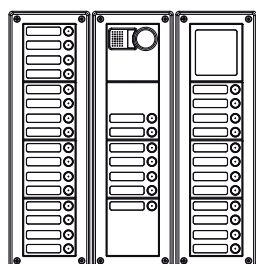

35

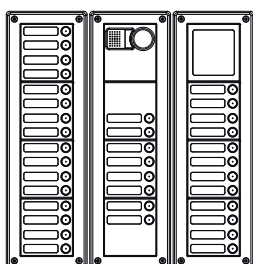

36

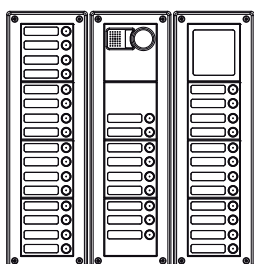

37

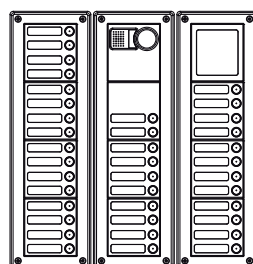

38

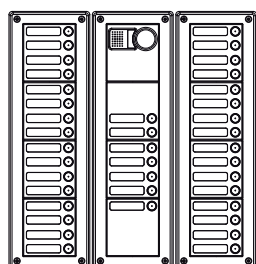

39

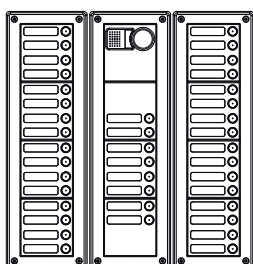

40

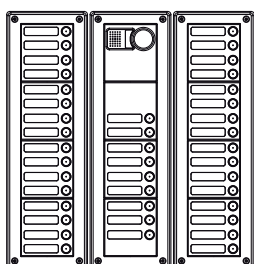

41

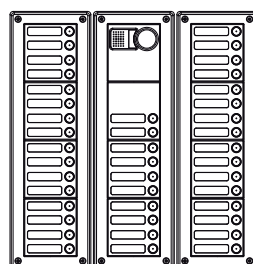

42

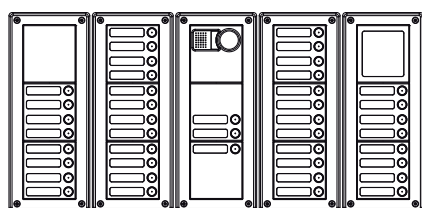

43

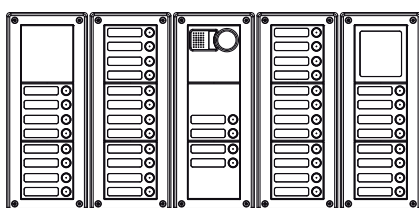

44

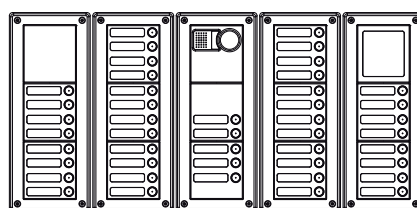

45

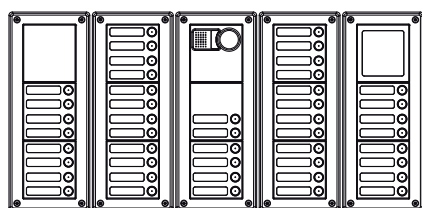

46

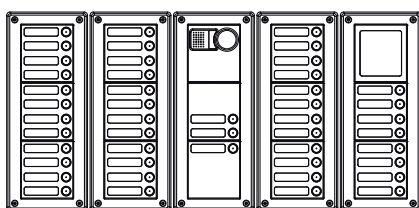

47

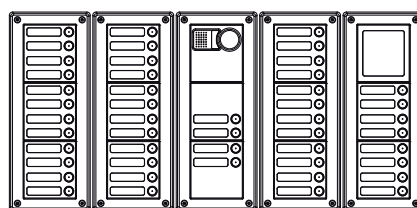

48



SINTHESI STEEL PUSH BUTTON PANEL

VIDEO DOOR PHONE SYSTEMS
MODULARITY EXAMPLES FOR DIFFERENT SYSTEM DIMENSIONS

urmet

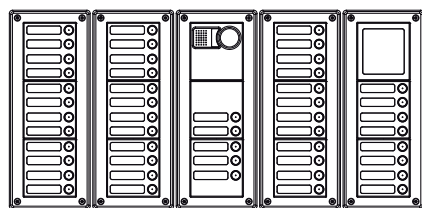

49

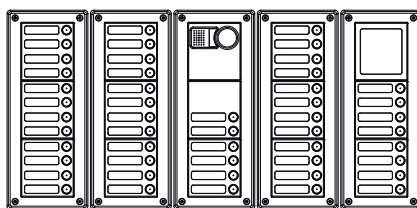

50

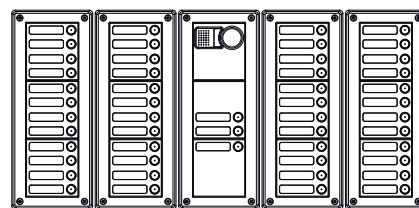

51

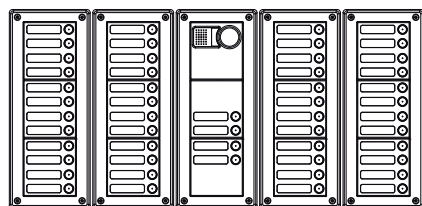

52

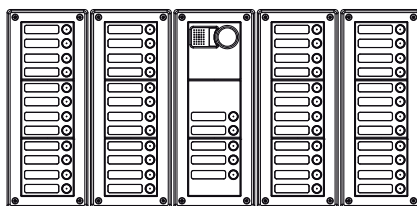

53

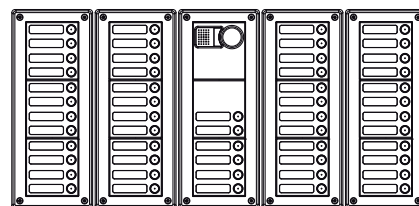

54

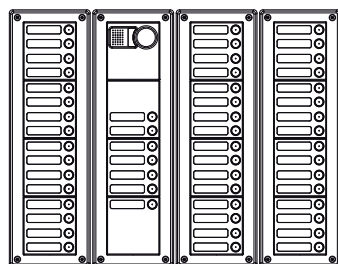

55

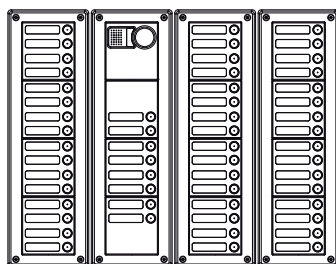

56

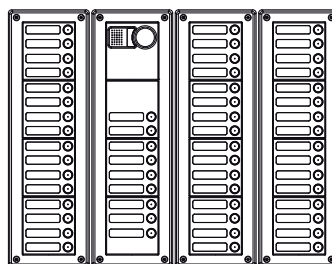

57

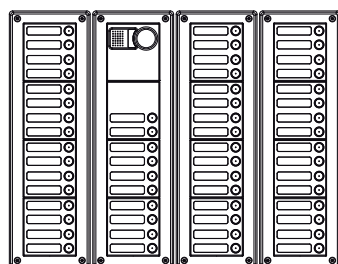

58



		BUTTONS NUMBER																														
		1	2	3	4	5	6	7	7h	8	8 _h	9	9 _h	10	10 _h	11	12	13	14	15	16	17	18	19	20	21	22	23	24	25	26	27
Button modules	1158/11			1				1	1							1				1				1				1				1
	1158/12				1					1	1						1				1				1				1			
	1158/13					1						1	1					1				1				1				1		
	1158/14						1	1	1	1	1	1	1	2	2	2	2	2	3	3	3	3	4	4	4	4	5	5	5	5	6	6
Special modules	1158/50															1	1	1	1													
Door unit modules	1083/6	1	1	1	1	1	1	1	1	1	1	1	1	1	1	1	1	1	1	1	1	1	1	1	1	1	1	1	1	1	1	1
1-button front unit	1758/107	1																														
Expansion module	1083/17			1	1	1	1	1	1	1	1	1	1	1	1	1	1	1	1	1	1	1	1	2	2	2	2	2	2	2	2	2
Flush mounting box	1158/42	1	1						2		2		2		2																	
	1158/43			1	1	1	1									2	2	2	2	2	2	2	2									3
	1158/44							1		1		1		1										2	2	2	2	2	2	2	2	
Module holders and frames	1158/62	1	1						2		2		2		2																	
	1158/63			1	1	1	1									2	2	2	2	2	2	2	2									3
	1158/64							1		1		1		1										2	2	2	2	2	2	2	2	
Rain hood	1158/612	1	1																													
	1158/613			1	1	1	1																									
	1158/614							1		1		1		1																		
	1158/624								1		1		1		1																	
	1158/626															1	1	1	1	1	1	1	1									
Case with hood (**)	1158/312	1	1																													
	1158/313			1	1	1	1																									
	1158/314							1		1		1		1																		

(**) Instead of products for flush mounting installatio: flush mount boxes, frames and module-holder frames and rain hoods.

		BUTTONS NUMBER																																
		28	29	30	31	32	33	34	35	36	37	38	39	40	41	42	43	44	45	46	47	48	49	50	51	52	53	54	55	56	57	58		
Button modules	1158/11				1				1				1				1				1				1				1					
	1158/12	1				1				1				1				1				1				1				1				
	1158/13		1				1				1				1				1				1				1				1			
	1158/14	6	6	7	7	7	7	8	8	8	8	9	9	9	9	10	10	10	10	11	11	11	11	12	12	12	12	13	13	13	13	14		
Special modules	1158/50				1	1	1	1	1	1	1					1	1	1	1	1	1	1	1	1										
	1158/59				1	1	1	1									1	1	1	1														
Door unit modules	1083/6	1	1	1	1	1	1	1	1	1	1	1	1	1	1	1	1	1	1	1	1	1	1	1	1	1	1	1	1	1	1	1	1	
Expansion module	1083/17	2	2	2	2	2	2	2	3	3	3	3	3	3	3	3	3	3	3	3	3	3	3	3	3	4	4	4	4	4	4	4	4	
Flush mounting box	1158/43	3	3	3													5	5	5	5	5	5	5	5	5	5	5	5						
	1158/44				3	3	3	3	3	3	3	3	3	3	3	3														4	4	4	4	
Module holders and frames	1158/63	3	3	3													5	5	5	5	5	5	5	5	5	5	5	5	5					
	1158/64				3	3	3	3	3	3	3	3	3	3	3	3														4	4	4	4	
Name holders lighting transformer	9000/230						1	1	1	1	1	1	1	1	1	1	1	1	1	1	1	1	1	1	1	1	1	1	1	1	1	1	1	



SINTHESI STEEL PUSH BUTTON PANEL

urmet

DOOR PHONE SYSTEMS
MODULARITY EXAMPLES FOR DIFFERENT SYSTEM DIMENSIONS

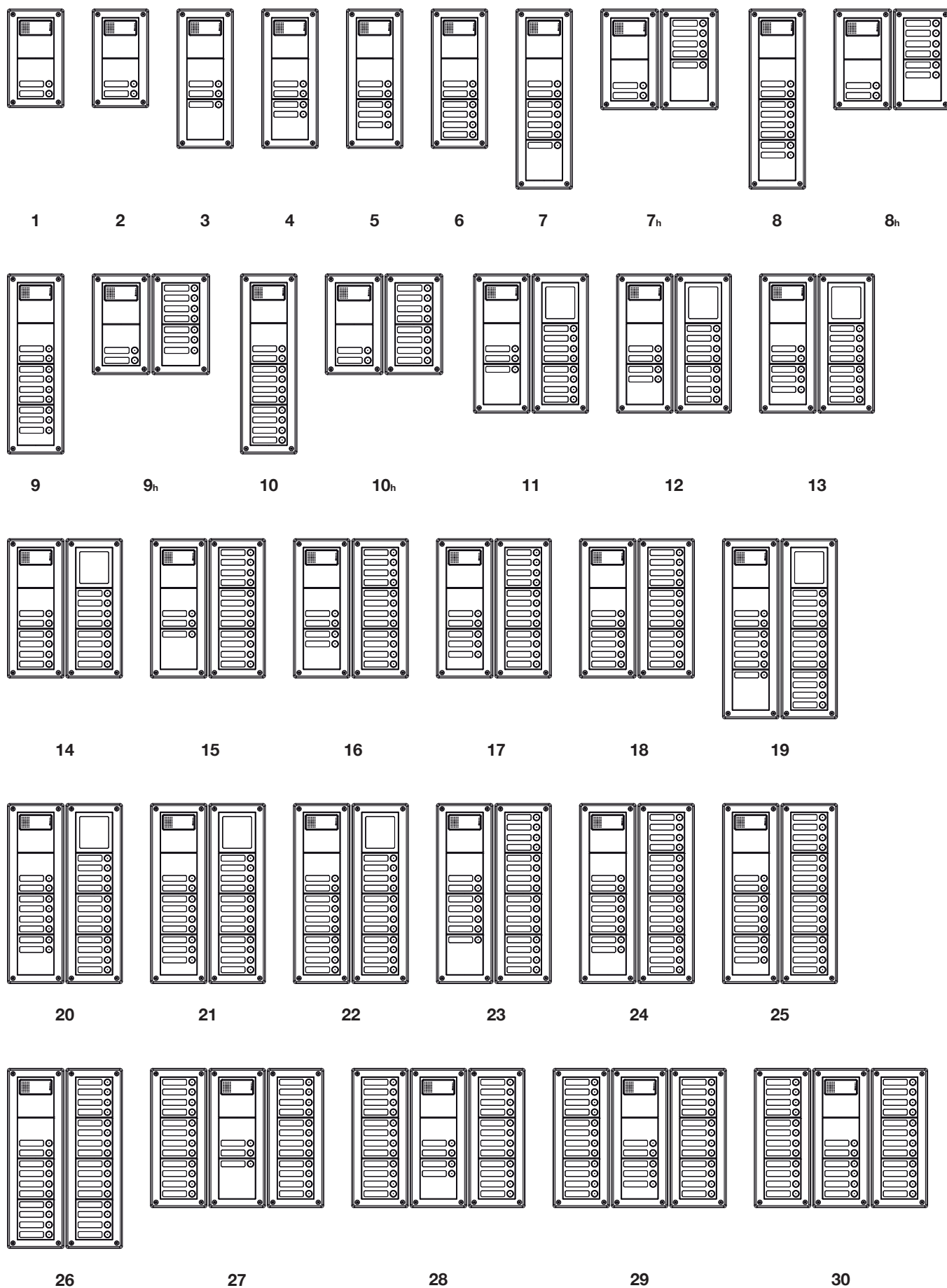

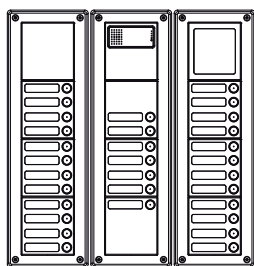

31

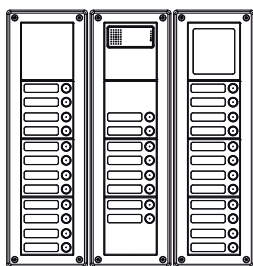

32

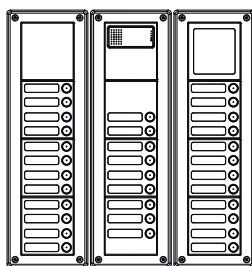

33

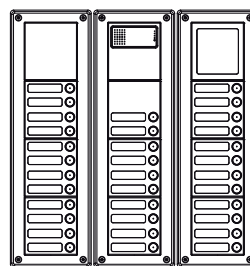

34

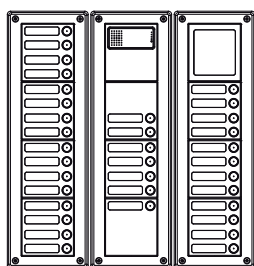

35

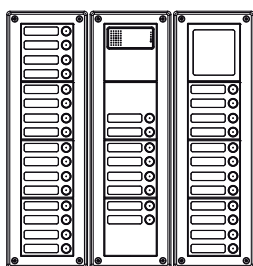

36

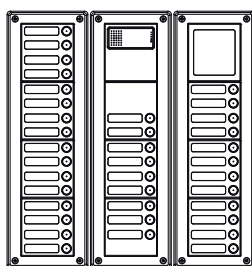

37

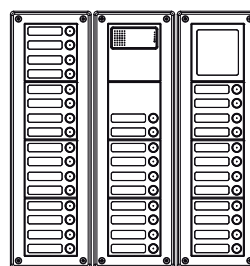

38

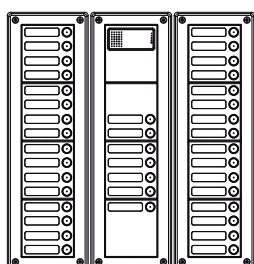

39

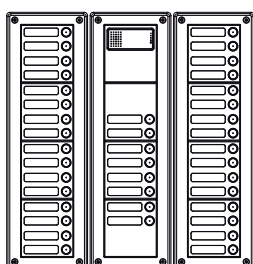

40

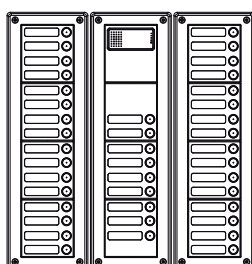

41

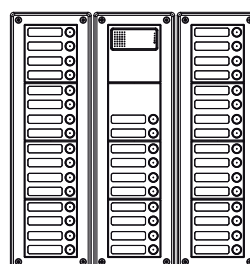

42

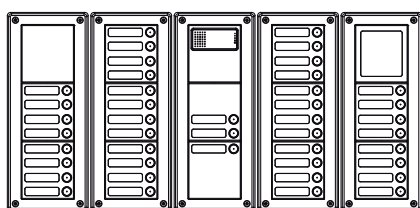

43

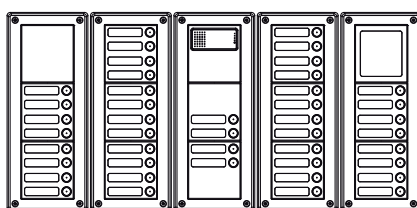

44

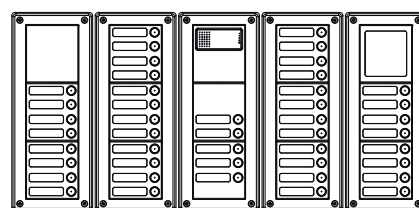

45

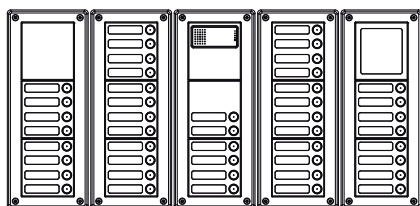

46

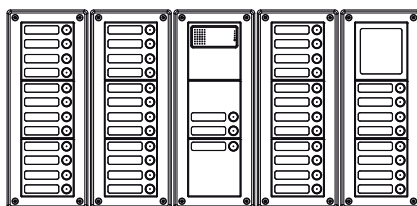

47

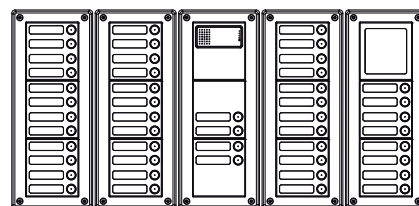

48



SINTHESI STEEL PUSH BUTTON PANEL

DOOR PHONE SYSTEMS
MODULARITY EXAMPLES FOR DIFFERENT SYSTEM DIMENSIONS

urmet

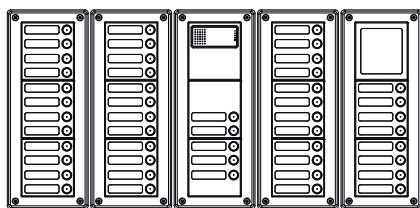

49

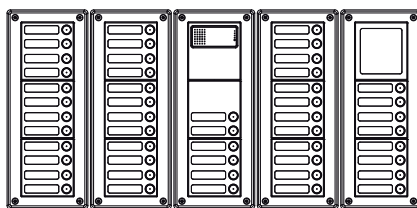

50

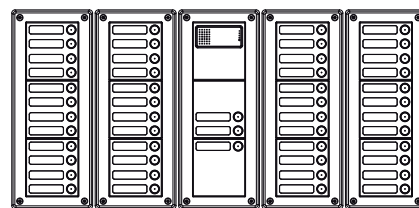

51

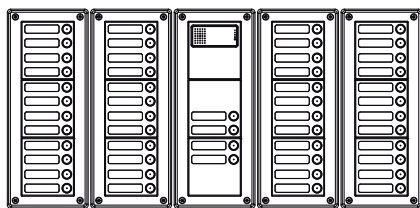

52

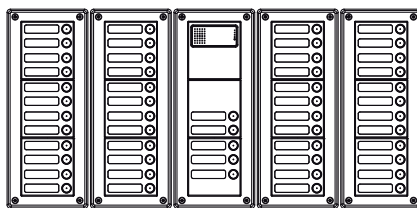

53

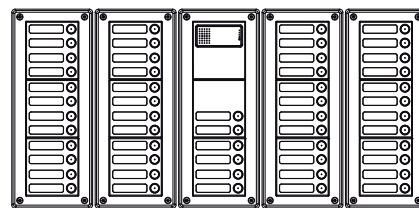

54

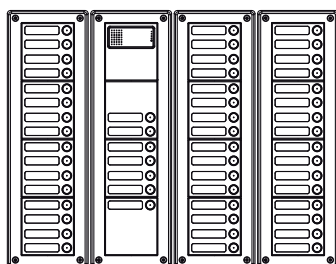

55

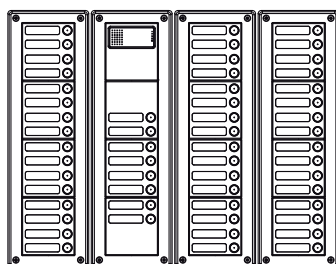

56

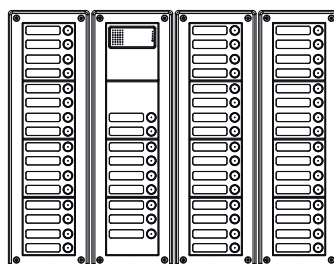

57

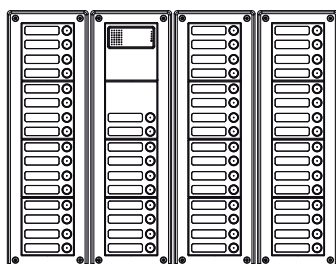

58



CONFIGURATION

ID: door unit identifier

- Each main call station must have a unique code (call ID, i.e. Identifier) that can be set with dip-switch with values 0÷3.
- In case of secondary call station the ID must be the same as the column ID configured on the column interface.

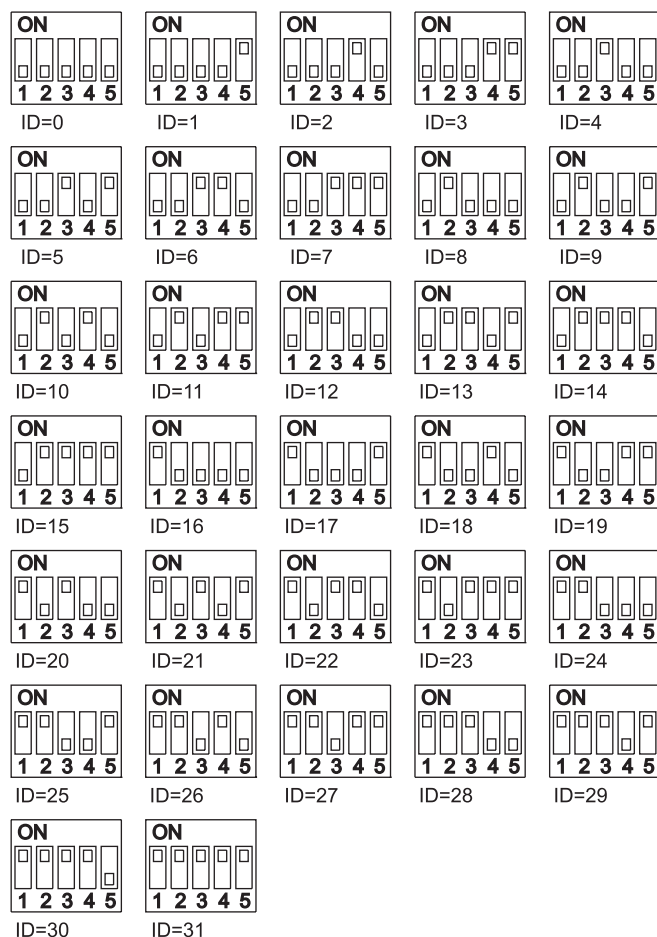

AUX: auxiliary settings

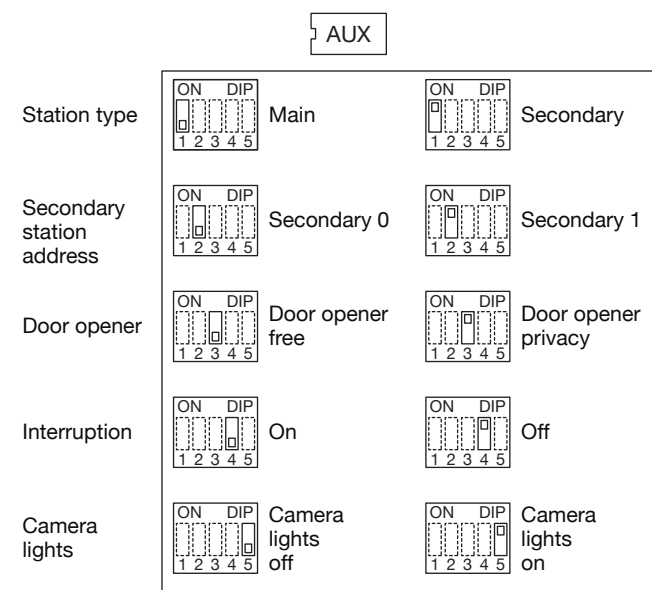

DIP1 - Station type

The door unit can be configured either as a main or a secondary device. All the users in the system may be called from the main door unit. A secondary door unit may only call the users of the column to which it belongs. Users can identify the source of the call by the ring tone.

DIP2 - Secondary station address

Two secondary calling stations may be present in a column and must have a different address (0 or 1).

DIP3 - Door opener

The electric lock can be managed in "privacy" or "free" mode. The door unit works as follows in the two cases:

- "Privacy": the electric lock may only be activated by pressing the door opening button on the calling station when an audio conversation has been established or when after having received a call or auto-on function either a video connection has been established.
- 'Free': when pressing the door lock release button of an apartment station, the door unit electric lock can be activated only if the door unit is configured as main or the user belongs to the column of the same secondary door unit. This column is defined by the ID setting of the secondary door unit. This function is typically used for secondary stations.

DIP4 - Interruption

Where is in progress an auto-on or an intercom conversation or the video door phone answering machine browsing, the respective column or the whole system is in busy mode, which, according to the configuration of this switch, can be interrupted or not by a call from the door unit.

The parameter "interruption" must be programmed in the same way for all system call stations.

DIP5 - Camera lights

The camera lights may be turned off if illumination in the surrounding environment is sufficient at night.

On the door unit module Ref. 1083/6 the position of this dip is irrelevant.

DOOR OPENING TIME The position of the rotary switch (DOOR TIME) determines the activation time of the door lock.



Pos. 0 = 1 s Pos. 1 = 10 s Pos. 2 = 20 s
Pos. 3 = 30 s Pos. 4 = 40 s Pos. 5 = 50 s
Pos. 6 = 60 s Pos. 7 = 70 s Pos. 8 = 80 s
Pos. 9 = 90 s/advanced programming

GUARANTEED CONVERSATION TIME: The position of the rotary switch (CONV TIME) determines a guaranteed conversation time, i.e. extends the busy time from the answer onwards. The busy time is equal to the reply time (max. 60s) added to the guaranteed conversation time.



The guaranteed conversation time must be programmed in the same way for all system call stations.

Pos. 0 = 1 s Pos. 1 = 10 s Pos. 2 = 20 s
Pos. 3 = 30 s Pos. 4 = 40 s Pos. 5 = 50 s
Pos. 6 = 60 s Pos. 7 e 8 = 70 s
Pos. 9 = advanced programming

To go to advanced configuration, put both the rotary switches on position 9.



SINTHESI STEEL PUSH BUTTON PANEL

ASSOCIATION OF DOOR UNITS BUTTONS TO USERS

urmet

ASSOCIATION OF DOOR UNITS BUTTONS TO USERS

Up to 62 buttons (besides the two buttons on the door unit station) can be connected to the door unit, using 4 add-on buttons units 1083/17 max.

MAIN DOOR UNITS

If the door unit is configured as main, buttons are automatically associated to column 0; this makes installation of main call stations easier in one-column systems.

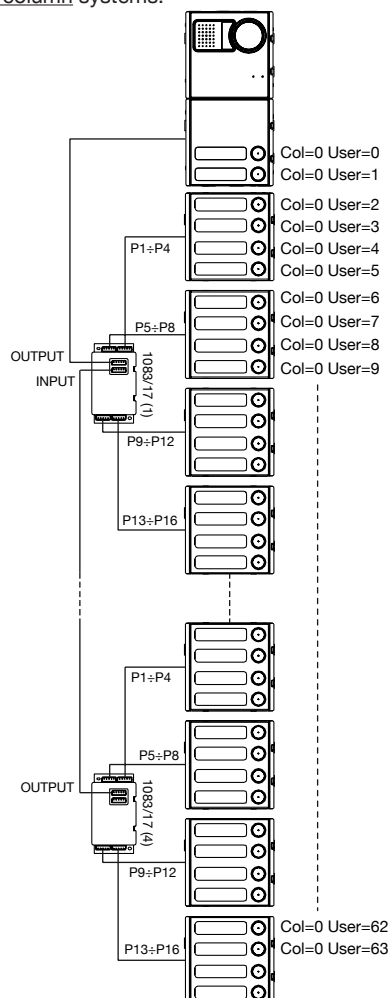

If the door unit is configured as main and in the system there are several columns, an association between buttons and users of the different columns is needed. Follow the instructions below:

1. Gain access to advanced configuration by rotating both the dip-switches in position 9 (the yellow led turns on).



2. Set the call station ID dip-switch to the code of the column to which the buttons must be associated.
3. Press the button associated to the user 0 of the selected column. All next buttons are automatically associated to the users of that column, in sequence.
4. Repeat steps 2 and 3 for all the columns.
5. Put again the ID dip-switches in their original position.

6. Quit the advanced configuration, by putting again the two rotary switches in the positions used to set door lock release time and guaranteed communication time. The yellow led switches off.
7. Repeat these operations for all main call stations.

Example:

System with 3 columns, the first one with 4 users, the second with 6 users, the third with 8 users.

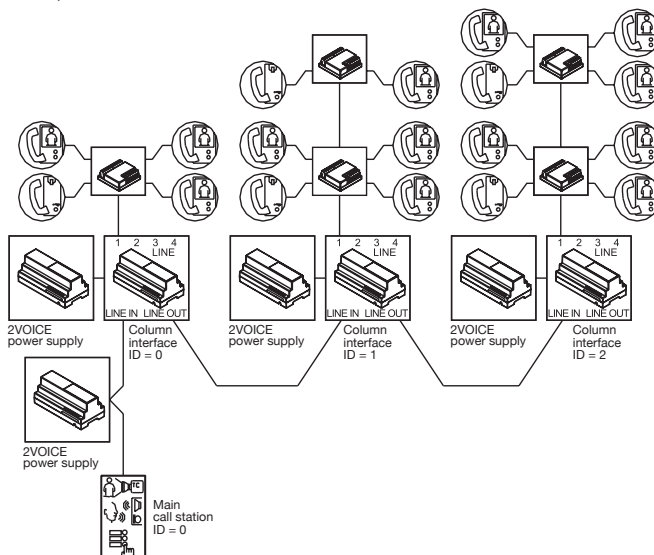

- Gain access to advanced configuration.
- Set the call station ID dip-switch to 0.
- Press the door unit upper button (the first button).
- Set the call station ID dip-switch to 1.
- Press the button 3 of the first buttons module (the fifth button), which is associated to the user 0 of the column 1.
- Set the call station ID dip-switch to 2.
- Press the first button of the third buttons module (the eleventh button) which is associated to the user 0 of the column 2.
- Put again the ID dip-switches in their original position.
- Quit the advanced configuration.

The final configuration is the following:

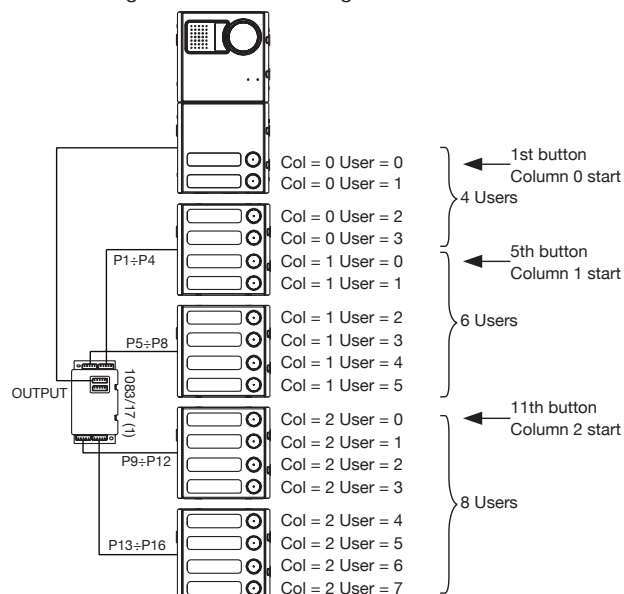



SECONDARY DOOR UNITS

In door units configured as secondary, buttons are associated by default to the users from 0 to 63 of their column.

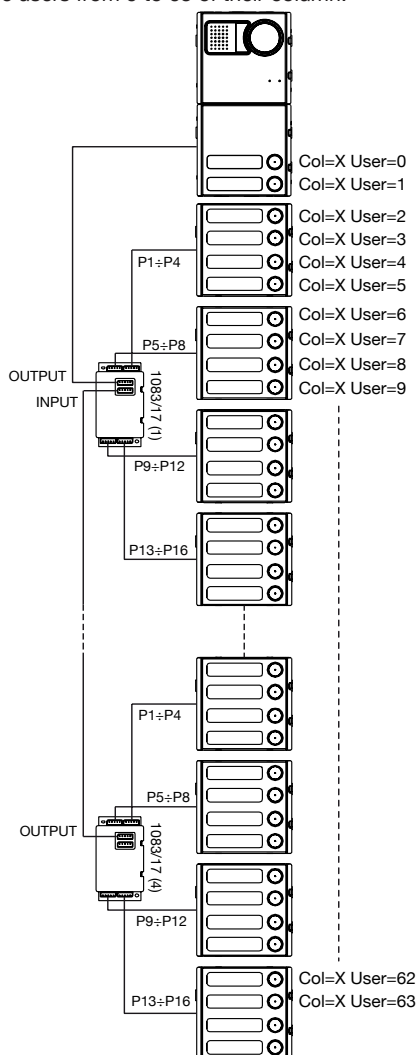

If the door units are configured as secondary, but each one must call a different group of users, follow the instructions below:

- Gain access to advanced configuration by rotating both the dip-switches in position 9 (the yellow led turns on);



- Set the call station ID dip-switch to the code of the apartment station which will be associated to the first button (offset);

The offset code must only be included between 0 and 31.

- Change AUX dip switch n. 5 position (the call station emits a confirmation tone);

- Put again the AUX dip switch n. 5 in its original position (the call station emits a confirmation tone);

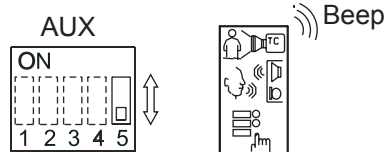

- Put again the ID dip-switches in their original position.
- Quit the advanced configuration, by putting again the two rotary switches in the positions used to set door lock release time and guaranteed communication time: the yellow led switches off.

Example:

The secondary call station "A" calls only users from 0 to 10, the call station "B" only users from 11 to 18.0

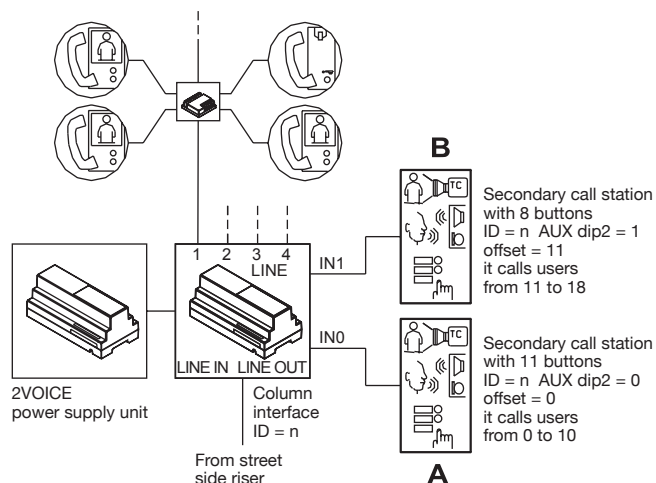

- On the call station "B", gain access to advanced configuration;
- Set ID dip-switch to 11;
- Move AUX dip switch n. 5;
- Put again all dip-switches in their original position;
- Quit the advanced configuration.



SINTHESI STEEL PUSH BUTTON PANEL



OPTIONAL PROGRAMMING PROGRAMMING DATA DELETING

OPTIONAL PROGRAMMING

AUTO-ON FUNCTION ON SURVEILLANCE CAMERAS

If in a call station there are surveillance cameras, this function must be programmed.

1. Gain access to the advanced configuration by rotating both rotary switches to position 9; the door unit emits a beep to indicate programming status and the yellow led turns on.

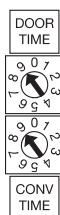

2. Press the entrance hall button (PA – CT) for many times as the number of installed surveillance cameras. Each time the button is pressed, the door unit emits a number of beeps equal to the number of programmed cameras (5 max.). By pressing again the buttons after the 5 beeps, the door unit emits a long beep, indicating that there are no cameras connected (default).

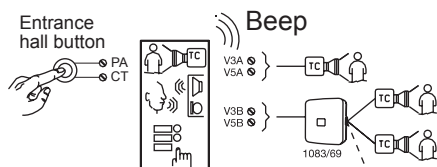

3. Put again the rotary switches in the correct position to quit the advanced configuration.
4. Repeat the programming procedure for all call stations with surveillance cameras.

According to the programmed number of cameras, the following configurations are available:

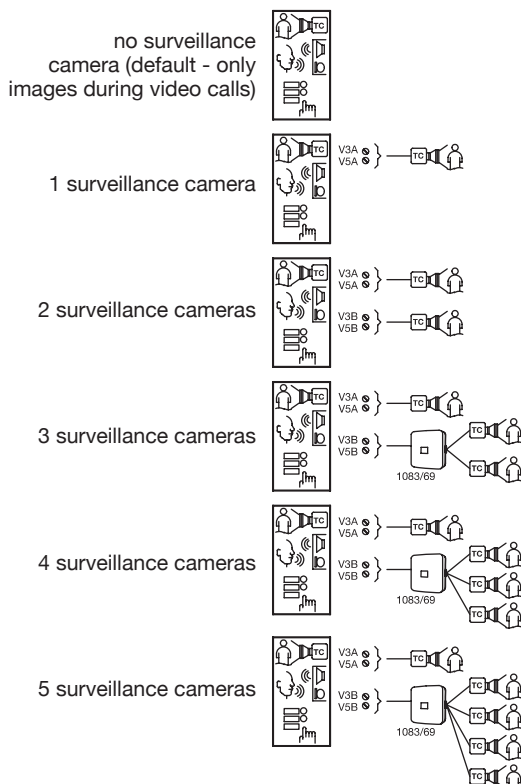

BUTTON CONFIGURATION FOR SPECIAL FUNCTION

It is possible to configure a button for a special function, for example to turn the stairs lights on.

To configure the button, perform as follows:

- Go to advanced configuration.



- Keep the selected button pressed for 3 seconds, the door unit emits an acoustic signal to confirm that the acquisition has been successfully performed.

The function can be activated only if a suitably programmed special decoder is installed.

PROGRAMMING DATA DELETING

1. Gain access to advanced programming by putting both the rotary switches in position 9.
2. Keep any call button pressed for at least 5 seconds (after the second beep), then release it.
3. Put again the rotary switches in their operating position.

In this way, buttons/users association, special function button association and surveillance cameras number are deleted.