



Exigo PANEL WITH DOOR UNIT AND DIGITISER

Download from www.urmet.com Technical Manuals area.

SECTION CONTENTS

PUSH BUTTON PANEL EXIGO	2	
ELECTRICAL AND MECHANICAL SPECIFICATIONS	2	
HOW TO FORM THE PANEL CODE	2	
LOUDSPEAKING UNIT WITH BUILT-IN		
DIGITALIZER DEVICE Ref. 1072/19A.....	3	
Performance	3	
Structure	3	
Description of terminal boards	3	
Technical specifications	3	
Default programming	4	
Connections	4	
Function.....	4	
Adjustments.....	4	
16-PUSHBUTTON EXPANSION MODULE Ref. 1038/17	5	
Description of terminals.....	5	
Technical specifications	5	
TV CAMERA UNIT	5	
Technical specifications	5	
Camera unit assembly	5	
Camera lens direction adjustment.....	6	
CAMERA ADAPTER Ref. 1742/13A	7	
Adapter installation.....	7	
PANELS FOR SINTHESI FLUSH-MOUNTING BOXES	8	
Flush-mounting boxes.....	8	
Door unit installation procedure	9	
Name tag back-lighting led fastening procedure	9	
Name tag assembly and front panel fastening procedure	10	
PANELS FOR DEDICATED FLUSH-MOUNTING BOXES	10	
Flush-mounting boxes.....	11	
Door unit installation procedure	11	
Name tag back-lighting led fastening procedure	12	
Name tag assembly and front panel fastening procedure	12	
		DOOR PHONE SYSTEMS IN SINTHESI BOXES
		Examples of modular constructions with various capacities
		13
		VIDEO DOOR PHONE SYSTEMS IN SINTHESI BOXES
		Examples of modular constructions with various capacities
		14
		DOOR PHONE SYSTEMS IN DEDICATED BOXES
		Examples of modular constructions with various capacities
		15
		VIDEO DOOR PHONE SYSTEMS IN DEDICATED BOXES
		Examples of modular constructions with various capacities
		16
		PROGRAMMING
		See section 1A



PUSH BUTTON PANEL EXIGO



ELECTRICAL AND MECHANICAL SPECIFICATIONS HOW TO FORM THE PANEL CODE

PUSH BUTTON PANEL EXIGO

PUSH BUTTON PANEL EXIGO

Exigo is the new, elegant and customisable, brass-plated Urmet panel.

A special space for an engraved plate is provided on the panel. The space may be used to fit plate showing the name of the building, the address, the street number and other information, on one or two lines. Two types of fonts may be chosen.

The basic panel is supplied with a brass panel to be engraved. Other two options are available upon request: an engraved brass plate or an anthracite grey PVC plate. You may choose what information to be written on the name tags (name, floor/apartment number, etc.) and the number of lines (1 or 2).

The name tags are backlit by a set of high-efficiency white LEDs. This feature may also be customised by purchasing a blue or green coloured film.

Polished brass-plate and matte brass-plate panels are available. The system is suitable for use in both door phone and video door phone systems (colour or black and white).

All parts of the front panel are treated by means of a ion plating protection process (PVD) to make them corrosion and rustproof. The panels are particularly resistant to weather elements.

The Exigo panels may be installed in Sinthesi flush-mounting boxes or in specific boxes.

All versions are complete with:

- LED name tag lighting unit.
- Brass-plate name tags to be engraved.
- Tamperproof screws and screwdriver.
- Drilling template for fastening the door unit (versions 1143 and 1743).

ELECTRICAL AND MECHANICAL SPECIFICATIONS

Front projection from wall:	17mm
Total button stroke:	>4mm
Idle button stroke:	>2.4mm
Isolation voltage between contacts:	500Vac
Max. button cut-off current:	2Aac
Name tag lighting:	white LED diodes
Temporary name tags:	Plexiglas
Max. wire cross-section area for button and light terminals:	1.5mm ²
Corrosion:	as per DIN 5342/64 standard
Test duration:	16 hours
Test temperature range:	35°C

IMPORTANT: Clean with a dry, soft cloth. Do not use brass polish.

HOW TO FORM THE PANEL CODE

Please provide a code formed as follows for ordering a customised part:

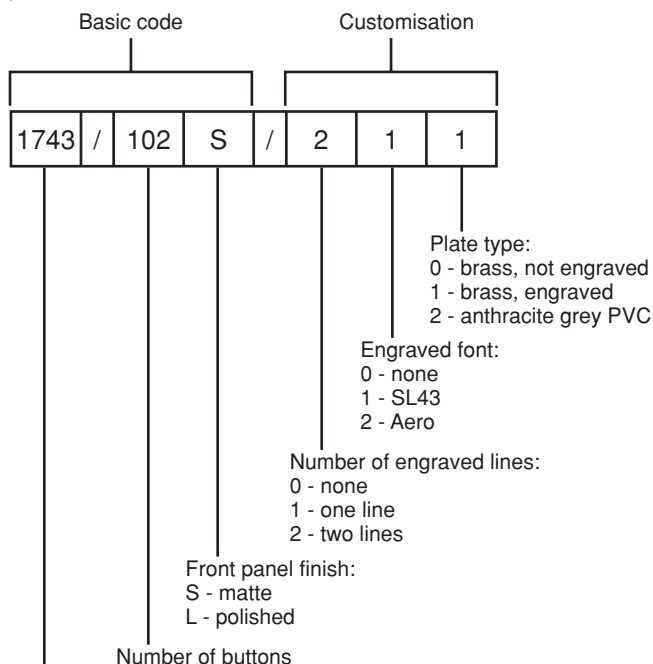

Front panel type:
1743 - video door phone in Sinthesi box
1143 - door phone in Sinthesi box
1721 - video door phone in dedicated box
1121 - door phone in dedicated box

EXAMPLE OF ENGRAVED FRONT PANEL

AERO FONT



SL43 FONT



EXAMPLE OF NAME TAG CUSTOMISATION

PVC PLATE - SL43 FONT

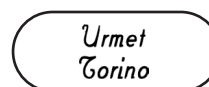

BRASS PLATE - STENCIL FONT



PUSH BUTTON PANELS



LOUDSPEAKING UNIT WITH BUILT-IN DIGITALIZER DEVICE Ref. 1072/19A

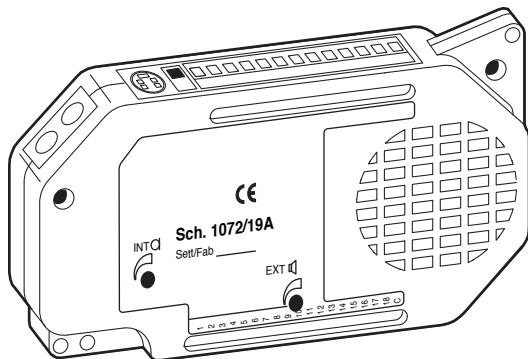

PERFORMANCE

- 18 user terminals which can be directly connected to buttons.
- Connector for 16 user expansion module Ref. 1038/17.
- Maximum four expansion modules (connected in series) can be potentially connected, up to 82 user buttons in each door unit.
- Possibility of assigning alphanumeric call button code with letter prefix or suffix A-J.
- The digitiser is programmed by means of an external programming device Ref. 1072/60 which in turn must be connected to a push-button panel Ref. 1032/65.
- Simplified programming with LED button and two dip-switches in simple systems.
- Possibility of programming one or more buttons for controlling a special decoder ("staircase lights" function).
- Electrical relay load control actuator with NC-C-NO outputs and programmable activation time, from 1 to 30s.
- Programmable door phone hang-up waiting time (10, 20, 30, 40s).
- Programmable minimum guaranteed conversation time (10, 20, 30, 40s).
- Maximum conversation time: 250s.
- Open door contact input.
- Hall button timed input.
- Acoustic call sent signal.
- Busy function signalled by busy tone when a button is pressed to busy time-out.
- Two trimmers for adjusting speaker and microphone volume.
- Opto-isolated control signal management for video door phone systems.
- Possibility of programming a pre-set button for direct switchboard calls (day state only).

STRUCTURE

The door unit with digitiser consists of the following parts:

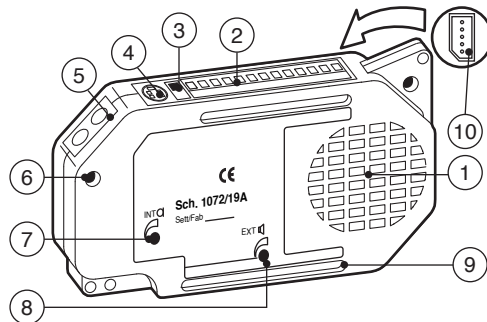

- 1 Speaker.
- 2 Main terminal board.
- 3 Simplified programming dip-switch.
- 4 Programming adapter connector Ref. 1072/60.
- 5 Simplified programming button and LED.
- 6 Microphone.
- 7 Microphone volume adjustment.
- 8 Speaker volume adjustment.
- 9 Button terminal board.
- 10 Expansion connector Ref. 1038/17.

DESCRIPTION OF TERMINAL BOARDS

System terminal boards

NO	Electrical lock relay normally open contact
NC	Electrical lock relay normally closed contact
C	Relay exchange electrical lock common contact
~12	Relay power for electrical lock
~0	Relay power for electrical lock
SN	Video power unit on signal for video door phone systems
R	Video switching enable signal for video door phone systems
R1	Video power earth
L1	Bus Line 1st connector
L2	Bus Line 2nd connector
GND	Reference earth PA, SP.
SP	Open door sensor contact input (closed with closed door)
PA	Hall door opener button input (normally open)

Button terminal boards

P1÷P18	User button inputs
C	Button reference earth

TECHNICAL SPECIFICATIONS

• Stand-by consumption:	6.5mA max.
• Active voice consumption:	40mA max.
• Relay contact:	30V 2A
• R, SN signal:	I_{max}=80mA
• Working temperature range:	-10 ÷ +50°C
• Humidity:	90% RH at 30°C



PUSH BUTTON PANEL EXIGO

LOUDSPEAKING UNIT WITH BUILT-IN DIGITALIZER DEVICE Ref. 1072/19A

urmet

PUSH BUTTON PANEL EXIGO

DEFAULT PROGRAMMING

Refer to section 1A "Programming" in this manual for how to program the device.

The device default settings are:

- System type: 2nd edition
- Station type: main
- Code format: numeric (0001-9999)
- Station number: 1
- Off-hook waiting time: 40s
- Busy time: 20s
- Door opener time: 3s

Code button association

LLLL	P1
1002	P2
.	.
.	.
.	.
1082	P82

To restore default settings, insert the programming device and hold bs (back space) button pressed for longer than three seconds until you hear a beep.

Alternatively, without the programming device, hold the programming button (5) pressed for longer than three seconds until you hear a beep.

CONNECTIONS

IMPORTANT: Observe the instructions contained in section 1 for wiring and maximum distances.

Up to 18 user buttons can be connected directly to the door unit. When a higher number of user is required, a Ref. 1038/17 expansion module can be connected. This allows the addition of 16 user buttons to the 18 basic buttons. Up to four expansion units can be potentially connected to each door unit, for a total of 82 user buttons.

Position two call units side by side if a station with more than 82 users is required. The door unit is programmed by default with a jumper between the earth and the "SP" signal to simulate the door closed contact. Remove the jumper and connect the sensor between GND and SP when the open door contact is required.

Internal calling station circuits are power by bus voltage.

FUNCTION

CALLS

Up to 82 users can be potentially called by pressing the corresponding buttons on the panels associated to the door unit with digitiser Ref. 1072/19A.

Additionally, a concierge switchboard Ref. 1072/42 can be called, simply by pressing a call button associated to code 0000 during programming (day mode only). A courtesy ring, similar to that generated on a called door phone, will be heard.

STAIRCASE LIGHTS FUNCTION

Press the button programmed for this function. A command will be sent to the special decoder and a confirmation beep will be heard. The staircase light function is assigned to button P1 by default.

If the staircase lights button is pressed during the programming procedure, it will be reprogrammed with the user code corresponding to the position.

BUSY FUNCTION

This function is only required in systems with more than one calling device. This function is used to ensure that a conversation lasts sufficiently long following a call. An intermittent beep will be heard on the speaker for the time before the busy time-out and the panel will be disabled.

Two cases can occur:

BUSY TIME BEFORE THE CALL USER GOES ON-HOOK

This is the maximum time for the user to lift the handset or open the door without losing the call after the ring.

BUSY TIME AFTER USER GOES ON-HOOK

This is the minimum guaranteed conversation time from when the handset is lifted.

ADJUSTMENTS

VOLUME REGULATION

Volume levels are calibrated by default so not to require adjustments in most cases.

Use a screwdriver to adjust the trimmers if required.

TROUBLESHOOTING

Establishing the cause of problems related to a door unit with digitiser Ref. 1072/19A is simple (e.g. no courtesy tone after a call button is pressed):

- Short-circuit on push-button panel side (L1, L2).
- Neither bus couplers are programmed as masters.

PUSH BUTTON PANELS



16-PUSHBUTTON EXPANSION MODULE Ref. 1038/17

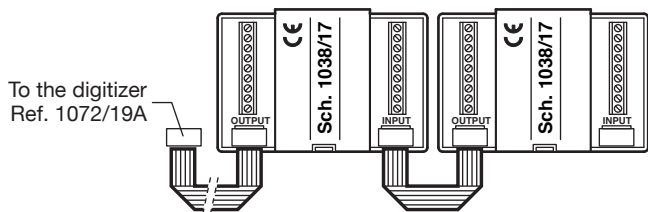

The extension module can be used to add 16 user buttons to the door unit.
Position the device in the panels as shown in the figures below under the LED circuits for lighting the name tags.
Connect the user buttons and connect the device to the door unit and to other extensions by means of the specific wire. Respect the connections directions.

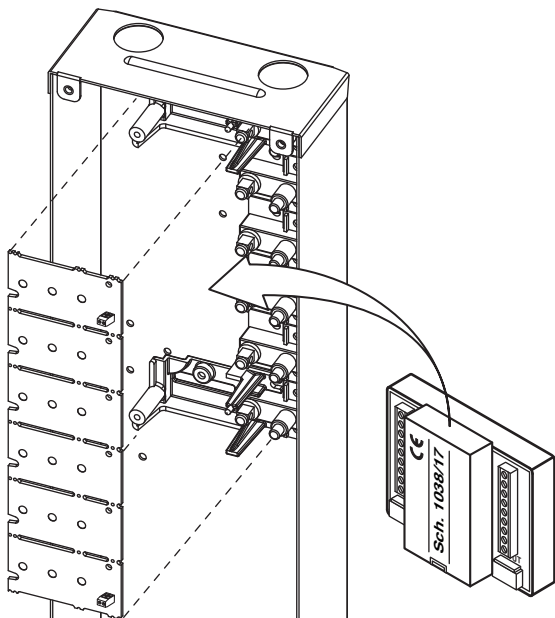

DESCRIPTION OF TERMINALS

- C Electrical reference earth for buttons 1-8
- P1...P8 User buttons
- C Electrical reference earth for buttons 9-16
- P9..P16 User buttons

TECHNICAL SPECIFICATIONS

- Consumption: **1mA Max**
- Current in user button: **~1mA**
- Working temperature range: **+0°C - +50°C**
- Humidity: **90% RH at 30°C**

TV CAMERA UNIT Ref. 1810/40

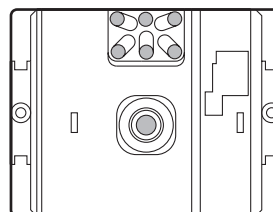

Easy to insert and extract from the front of the panel, the camera unit is provided with:

- Fixed focus camera with built-in optics and shutter.
- Possibility of adjusting camera lens vertically and horizontally.
- Set of infrared LEDs for illuminating the subject.
- Extractable connection terminal board.

TECHNICAL SPECIFICATIONS

Lens:	standard
Shutter:	standard
Focus:	fixed
Minimum light for acceptable pictures:	0,2 Lux min
Coax video output:	1Vpp composite
Frequency:	CCIR 50Hz
Operating temperature range:	-5 ÷ 50°C
Power voltage:	13 ÷ 26 Vdc
Maximum uptake:	120 Max
Image sensor:	CCD 1/4"

CAMERA UNIT ASSEMBLY

Proceed as follows for fixing the camera unit to the front panel:

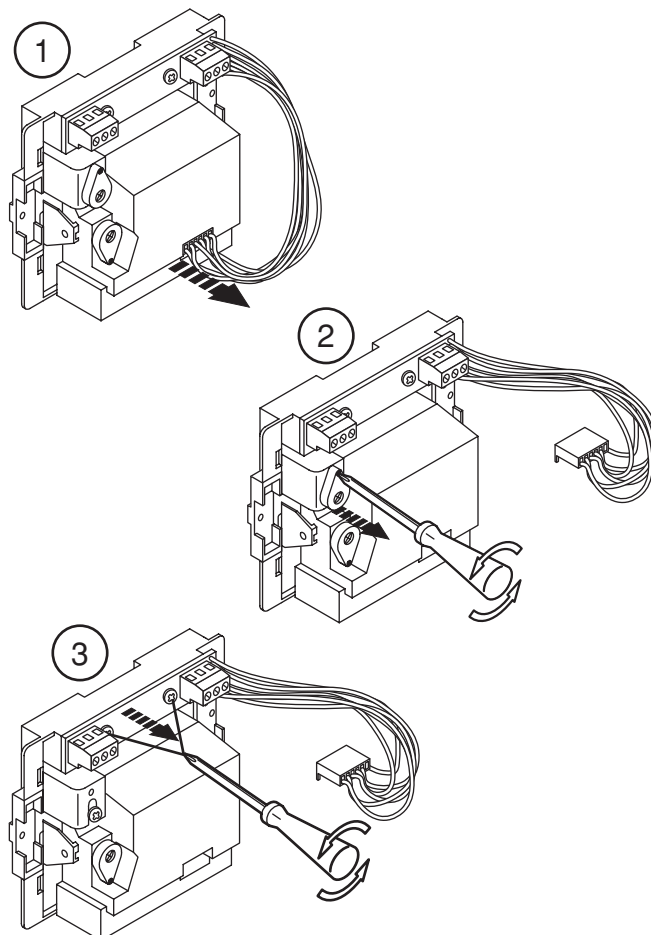

PUSH BUTTON PANEL EXIGO

PUSH BUTTON PANELS



PUSH BUTTON PANEL EXIGO

TV CAMERA UNIT

urmet

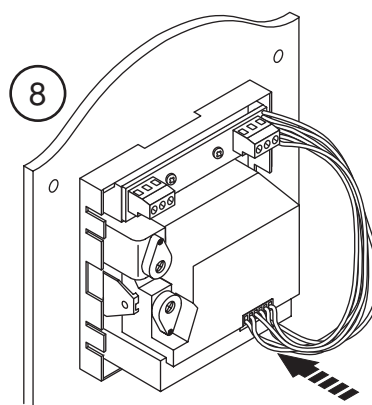
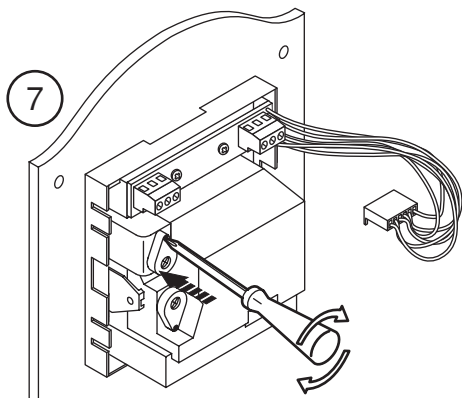
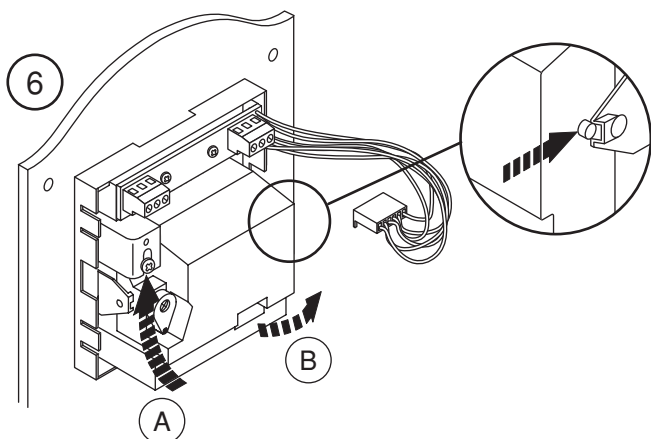
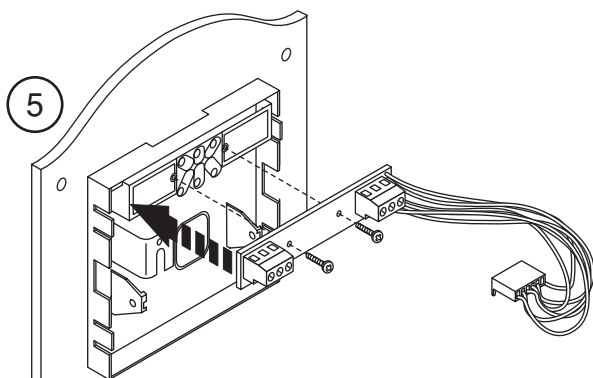
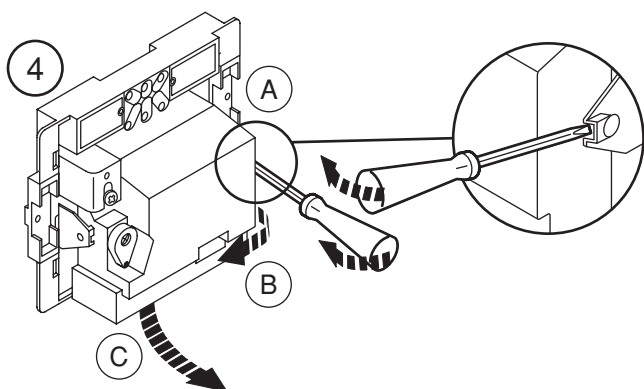

DESCRIPTION OF TERMINAL BOARDS

T	Camera on control in digital systems
R2	Camera power positive in digital systems
+TC	Camera power positive in analogic systems
R1	Camera power negative
V5/B	Video signal earth
V3/A	Video signal

CAMERA LENS DIRECTION ADJUSTMENT

With this TV camera unit, it is possible to adjust the direction of the TV camera lens inside it using the specific adjustment screws A and B in order to overcome any installation flaws.

The adjustment along the vertical axis in relation to the position set is 10° up and 20° down.

Adjustment along the horizontal axis in relation the position set is 10° in both directions (left-right).

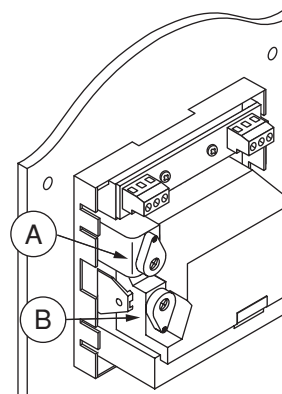

Orientation along the vertical axis

Turning screw A:

- In a clockwise direction (to the right) moves the pick-up field towards the top of the screen.
- In a counterclockwise direction (to the left) moves the pick-up field towards the bottom of the screen.

Orientation along the horizontal axis

Turning screw B:

- In a clockwise direction (to the right) moves the pick-up field towards the left the screen.
- In a counterclockwise direction (to the left) moves the pick-up field towards the right of the screen.



IMAGING ANGLES

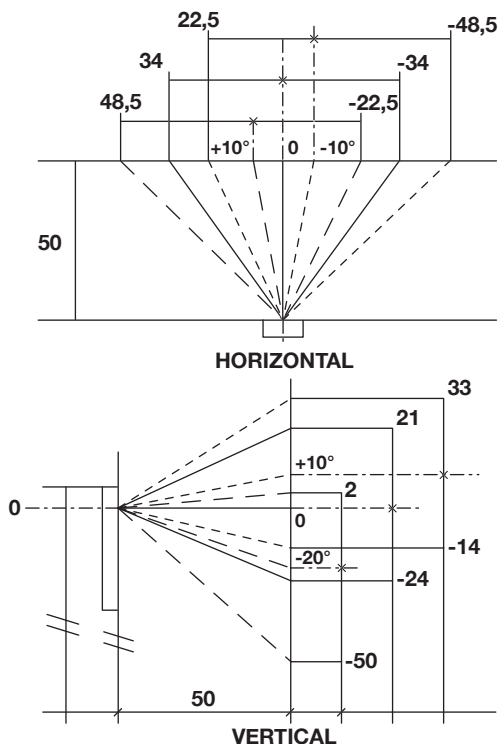

CAMERA ADAPTER Ref. 1742/13A

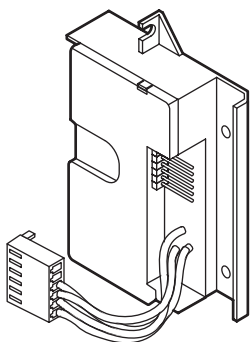

The device is used in Bibus II[^] Ed. VOP video door phone systems. It transforms the composite video signal from the camera into two different video signals (A and B).

ADAPTER INSTALLATION

1. Insert the adapter device to the side of the TV camera unit and secure it with the screw provided.
2. Remove connector **A** from the TV camera module.
3. Insert connector **A** in the coupling of the device and connector **B** in the coupling of the TV camera.
4. Position the conductors inside the groove of the device.

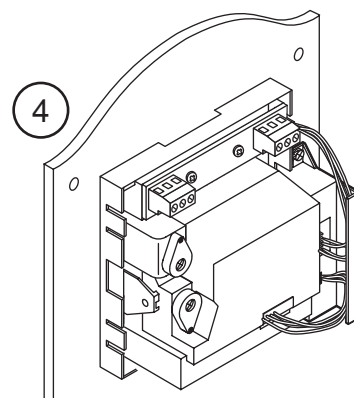
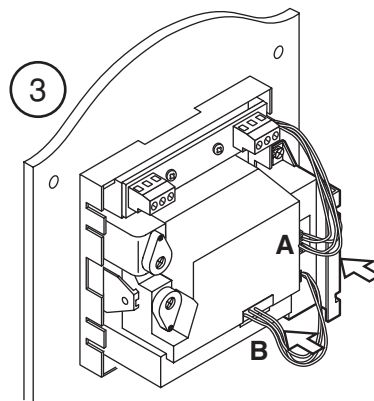
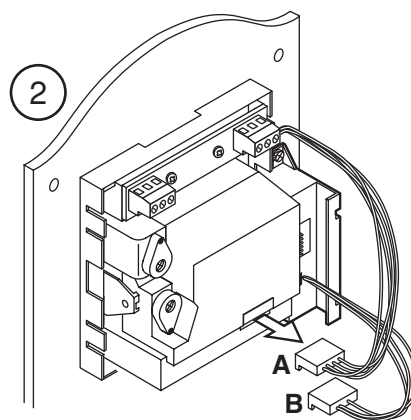
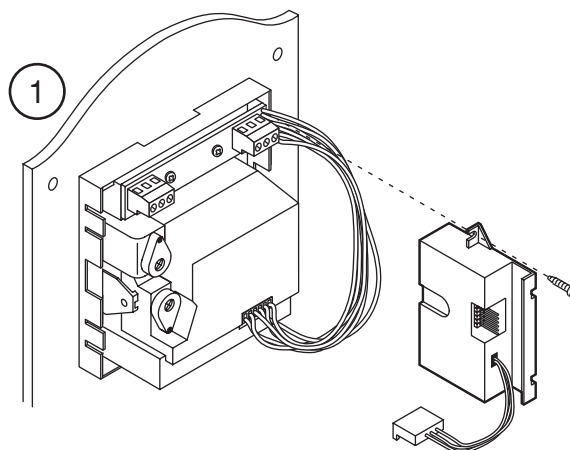

PUSH BUTTON PANEL EXIGO

PUSH BUTTON PANELS



PUSH BUTTON PANEL EXIGO



PANELS FOR SINTHESI FLUSH-MOUNTING BOXES

PUSH BUTTON PANEL EXIGO

PANELS FOR SINTHESI FLUSH-MOUNTING BOXES

This range of panels is suitable for installation in systems from 1 to 10 users. Sinthesi flush-mounting boxes adapted by means of a spacer are used.

The front panels are arranged for door unit installation. The following models are available:

Door phone panels

with 1 calling button	Ref. 1143/101
with 2 calling buttons	Ref. 1143/102
with 3 calling buttons	Ref. 1143/103
with 4 calling buttons	Ref. 1143/104
with 5 calling buttons	Ref. 1143/105
with 6 calling buttons	Ref. 1143/106
with 7 calling buttons	Ref. 1143/107
with 8 calling buttons	Ref. 1143/108
with 9 calling buttons	Ref. 1143/109
with 10 calling buttons	Ref. 1143/110

Video door phone panels

with 1 calling button	Ref. 1743/101
with 2 calling buttons	Ref. 1743/102
with 3 calling buttons	Ref. 1743/103
with 4 calling buttons	Ref. 1743/104
with 5 calling buttons	Ref. 1743/105
with 6 calling buttons	Ref. 1743/106
with 7 calling buttons	Ref. 1743/107
with 8 calling buttons	Ref. 1743/108
with 9 calling buttons	Ref. 1743/109
with 10 calling buttons	Ref. 1743/110

Fill in the order form and specify the required customisations by using the complete code formed as explained in the "How to form the panel code" paragraph.

FLUSH-MOUNTING BOXES

A different box than shown in the following table must be used according to the panel model to be installed:

Front panel code	Flush-mounting box code
Ref. 1143/101	Ref. 1145/52
Ref. 1143/102	
Ref. 1143/103	Ref. 1145/53
Ref. 1143/104	
Ref. 1143/105	
Ref. 1143/106	2 x Ref. 1145/52
Ref. 1143/107	
Ref. 1143/108	2 x Ref. 1145/53
Ref. 1143/109	
Ref. 1143/110	Ref. 1145/53
Ref. 1743/101	
Ref. 1743/102	Ref. 1145/54
Ref. 1743/103	
Ref. 1743/104	
Ref. 1743/105	
Ref. 1743/106	2 x Ref. 1145/53
Ref. 1743/107	
Ref. 1743/108	
Ref. 1743/109	
Ref. 1743/110	

System wires lead into the boxes through the openings on the sides and bottom of the box. All openings are shut by removable closures.

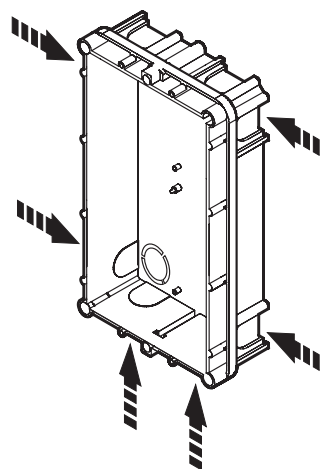

FLUSH-MOUNTING BOXES JOINING PROCEDURE

Two fairlead spacers for joining the boxes are provided with flush-mounting boxes Ref. 1145/52-/53-/54 modules. All the spacers are hollow to allow the passage of wires from one box to the other.

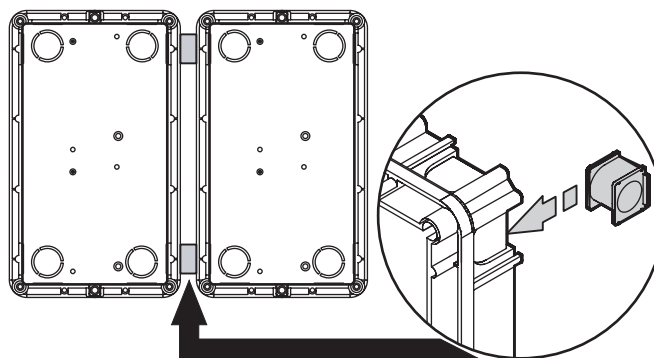

FLUSH-MOUNTING BOX INSTALLATION PROCEDURE

The spacer Ref. 1143/60 must be fixed to each of the flush-mounting boxes. A standard sized spacer is provided. For flush-mounting boxes Ref. 1145/52 or Ref. 1145/53, break the spacer along the pre-cutting for correct assembly.

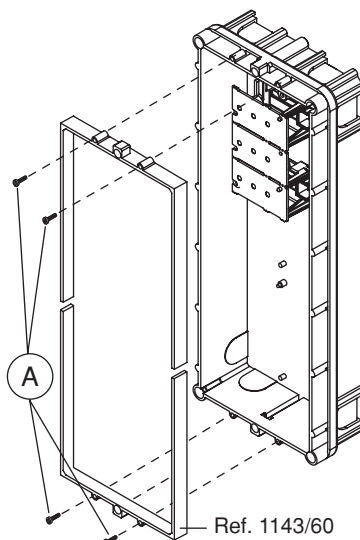

PUSH BUTTON PANELS



Screws A (3.5 x 16mm) are provided with the spacer.
 The box and spacer must be installed flush with the wall without protruding at a height of approximately 1.55 ÷ 1.60m from the floor.
 The flush-mounting depth of all boxes is equal to 60mm (45mm for the box + 15mm for the spacer).

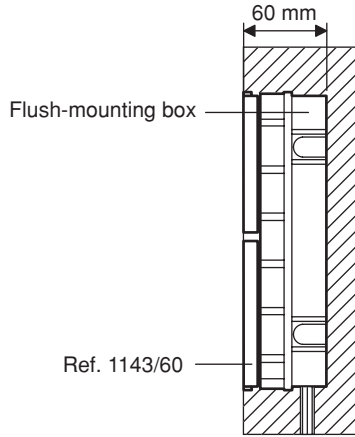

DOOR UNIT INSTALLATION PROCEDURE

Do not fit the seal on the microphone provided with the door unit.

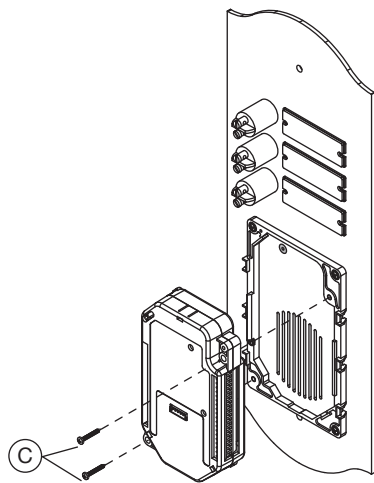

Screws C are included with the front panel and not with the door unit.

NAME TAG BACK-LIGHTING LED FASTENING PROCEDURE

Use the template provided with the front panel to fasten the name tag lighting LEDs. Cut all the flush-mounting box columns shown by , and then drill at the points indicated by .

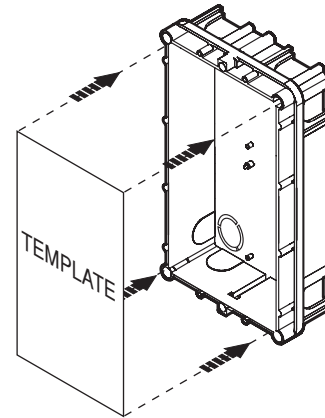

Fix the spacers to the flush-mounting box and fix the LED circuit to the spacers.

SINGLE LED CIRCUIT

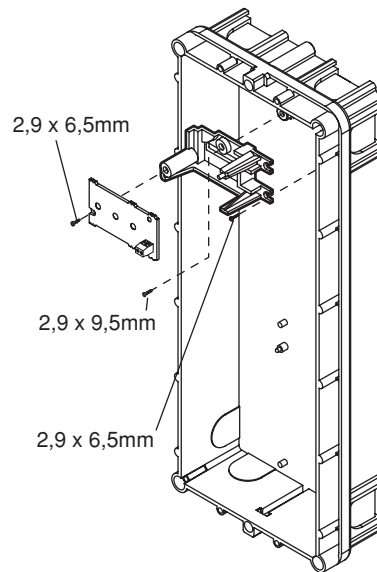

MULTIPLE LED CIRCUIT

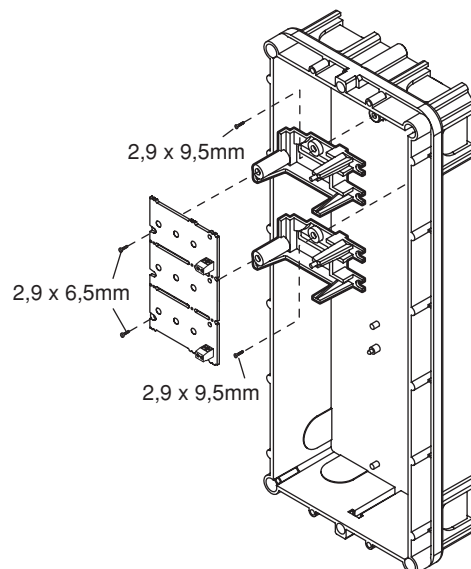



PUSH BUTTON PANEL EXIGO

PANELS FOR DEDICATED FLUSH-MOUNTING BOXES



PUSH BUTTON PANEL EXIGO

NAME TAG ASSEMBLY AND FRONT PANEL FASTENING PROCEDURE

Exigo panels are provided with a brass name tag (not engraved) which may be replaced by an engraved brass name tag or an anthracite grey PVC name tag.

Coloured film (each box contains 5 pieces in two colours) may be used to customise the colour of the backlighting:

- Blue
- Green

Ref. 1143/51

Ref. 1143/52

Proceed as shown in the following drawings for fitting the coloured film and the name tags.

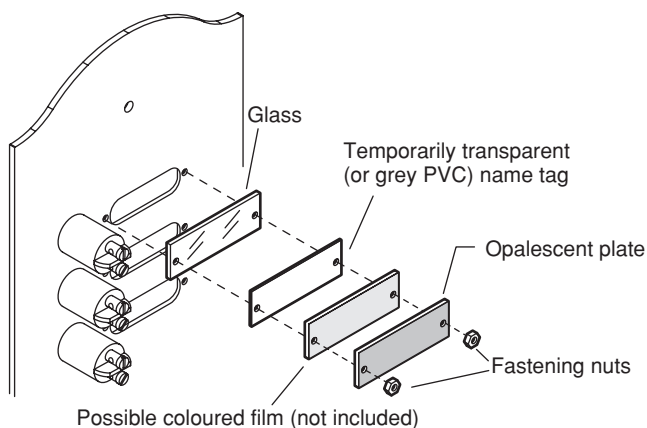
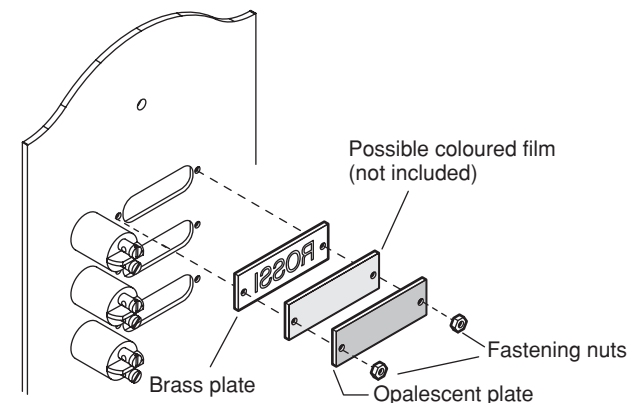

Close the panel front using the tamperproof screws provided at the end of the operations:

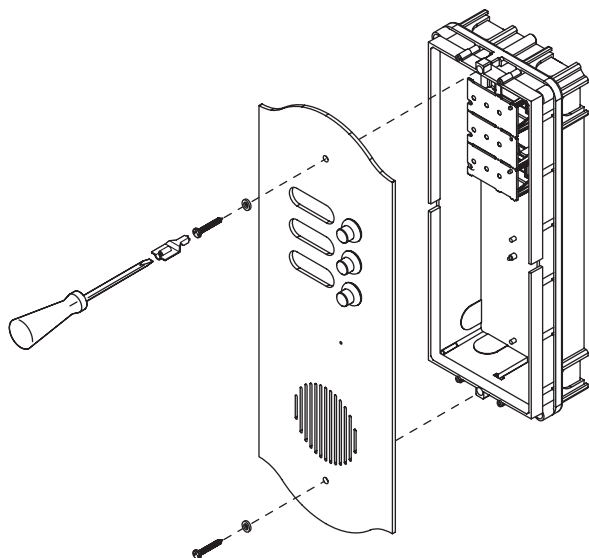

PUSH BUTTON PANELS

PANELS FOR DEDICATED FLUSH-MOUNTING BOXES

This panel range is designed for use in systems from 3 to 20 users. Dedicated flush-mounting boxes are used.

The front panels are arranged for door unit installation. The following models are available:

Door phone panels with 1 row of buttons

with 3 calling buttons	Ref. 1121/103
with 4 calling buttons	Ref. 1121/104
with 5 calling buttons	Ref. 1121/105
with 6 calling buttons	Ref. 1121/106

Door phone panels with 2 rows of buttons

with 4 calling buttons	Ref. 1121/204
with 6 calling buttons	Ref. 1121/206
with 8 calling buttons	Ref. 1121/208
with 10 calling buttons	Ref. 1121/210
with 12 calling buttons	Ref. 1121/212
with 14 calling buttons	Ref. 1121/214
with 16 calling buttons	Ref. 1121/216
with 18 calling buttons	Ref. 1121/218
with 20 calling buttons	Ref. 1121/220

Video door phone panels with 1 row of buttons

with 3 calling buttons	Ref. 1721/103
with 4 calling buttons	Ref. 1721/104
with 5 calling buttons	Ref. 1721/105
with 6 calling buttons	Ref. 1721/106

Video door phone panels with 2 rows of buttons

with 4 calling buttons	Ref. 1721/204
with 6 calling buttons	Ref. 1721/206
with 8 calling buttons	Ref. 1721/208
with 10 calling buttons	Ref. 1721/210
with 12 calling buttons	Ref. 1721/212
with 14 calling buttons	Ref. 1721/214
with 16 calling buttons	Ref. 1721/216
with 18 calling buttons	Ref. 1721/218
with 20 calling buttons	Ref. 1721/220

Fill in the order form and specify the required customisations by using the complete code formed as explained in the "How to form the panel code" paragraph.



FLUSH-MOUNTING BOXES

A different box than shown in the following table must be used according to the panel model to be installed:

Front panel code	Flush-mounting box code	Dimensions of flush-mounting box
Ref. 1121/103	Ref. 1121/53	110 x 256 mm
Ref. 1121/104	Ref. 1121/54	110 x 284 mm
Ref. 1121/105	Ref. 1121/55	110 x 312 mm
Ref. 1121/106	Ref. 1121/56	110 x 340 mm
Ref. 1121/204 Ref. 1121/206	Ref. 1121/60	186 x 228 mm
Ref. 1121/208 Ref. 1121/210	Ref. 1121/62	186 x 284 mm
Ref. 1121/212	Ref. 1121/64	186 x 312 mm
Ref. 1121/214	Ref. 1121/65	186 x 340 mm
Ref. 1121/216	Ref. 1121/66	186 x 368 mm
Ref. 1121/218	Ref. 1121/67	186 x 396 mm
Ref. 1121/220	Ref. 1121/68	186 x 424 mm
Ref. 1721/103	Ref. 1721/53	110 x 340 mm
Ref. 1721/104	Ref. 1721/54	110 x 368 mm
Ref. 1721/105	Ref. 1721/55	110 x 396 mm
Ref. 1721/106	Ref. 1721/56	110 x 424 mm
Ref. 1721/204	Ref. 1721/60	186 x 312 mm
Ref. 1721/206	Ref. 1721/61	186 x 312 mm
Ref. 1721/208	Ref. 1721/62	186 x 340 mm
Ref. 1721/210	Ref. 1721/63	186 x 368 mm
Ref. 1721/212	Ref. 1721/64	186 x 396 mm
Ref. 1721/214	Ref. 1721/65	186 x 424 mm
Ref. 1721/216	Ref. 1721/66	186 x 452 mm
Ref. 1721/218	Ref. 1721/67	186 x 480 mm
Ref. 1721/220	Ref. 1721/68	186 x 508 mm

The flushing depth for all boxes is 55 mm.
System wires lead into the boxes through the openings on the bottom of the box.
All openings are shut by removable closures.

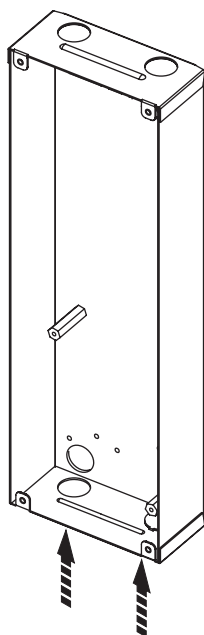

FLUSH-MOUNTING BOX INSTALLATION PROCEDURE

Apply adhesive labels to protect the front panel fastening holes during the embedding operation.

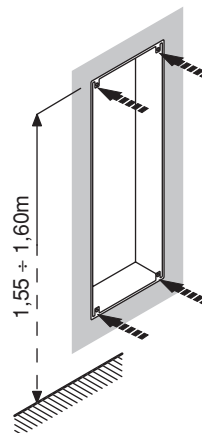

The box must be installed flush with the wall without protruding at a height of approximately 1.55 ÷ 1.60m from the floor.

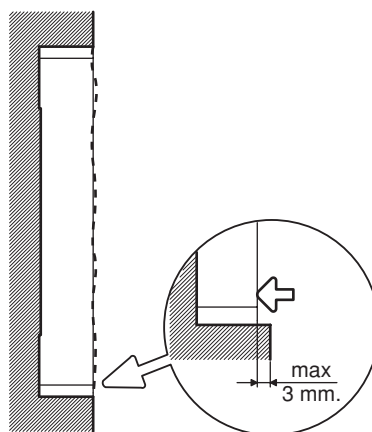

The wall surface must be flat. Maximum permitted tolerance = 1.5 mm.

DOOR UNIT INSTALLATION PROCEDURE

1 ROW OF BUTTONS

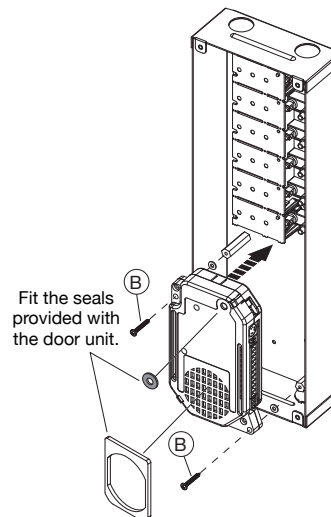



PUSH BUTTON PANEL EXIGO

PANELS FOR DEDICATED FLUSH-MOUNTING BOXES



PUSH BUTTON PANEL EXIGO

2 ROWS OF BUTTONS

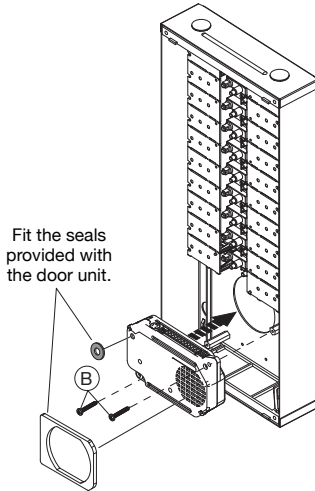

Screws B are provided with the door unit.

NAME TAG BACK-LIGHTING LED CIRCUIT FASTENING PROCEDURE

Proceed as follows to fasten the name tag lighting LEDs:
Fix the spacers to the flush-mounting box and fix the LED circuit to the spacers.

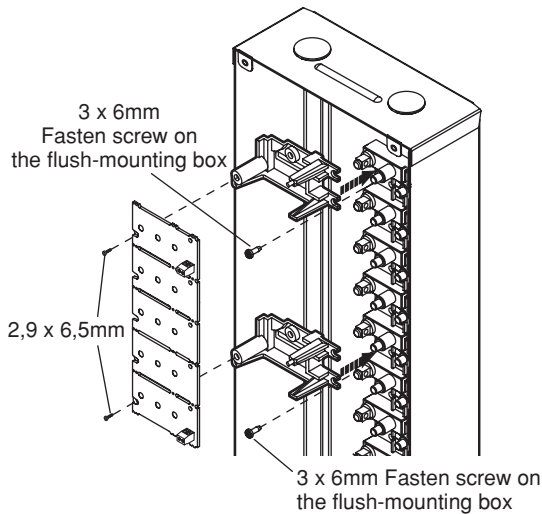

NAME TAG ASSEMBLY AND FRONT PANEL FASTENING PROCEDURE

Exigo panels are provided with a brass name tag (not engraved) which may be replaced by an engraved brass name tag or an anthracite grey PVC name tag.

Coloured film (each box contains 5 pieces in two colours) may be used to customise the colour of the backlighting:

- Blue
- Green

Ref. 1143/51
Ref. 1143/52

Proceed as shown in the following drawings for fitting the coloured film and the name tags.

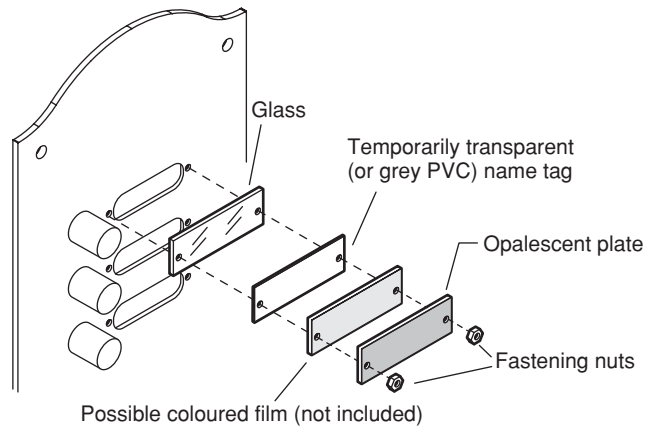
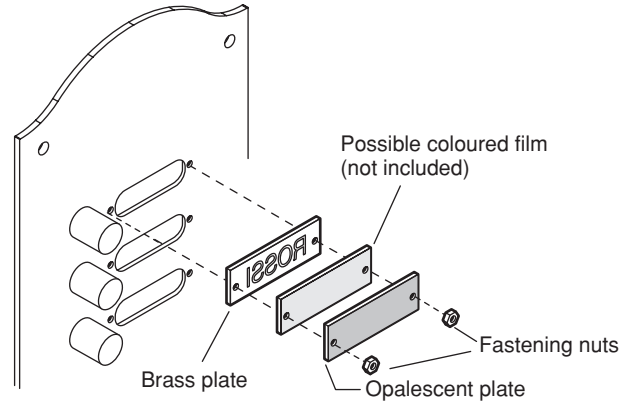

Close the panel front using the tamperproof screws provided at the end of the operations:

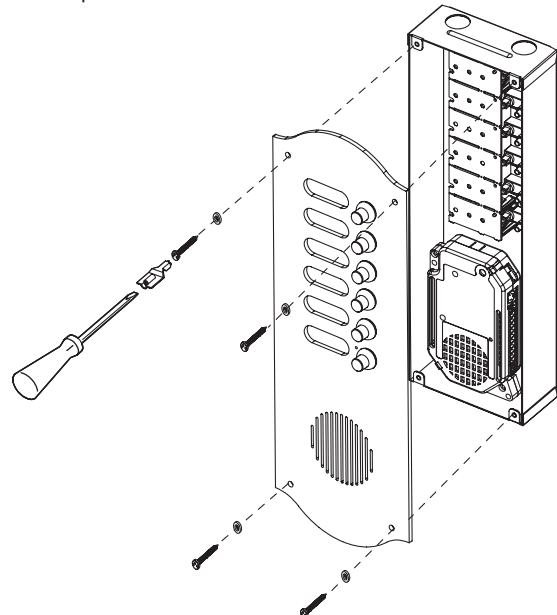

PUSH BUTTON PANELS



EXAMPLES OF MODULAR CONSTRUCTIONS WITH VARIOUS CAPACITIES

		BUTTONS NUMBER									
		1	2	3	4	5	6	7	8	9	10
FRONT	1143/101	1									
	1143/102		1								
	1143/103			1							
	1143/104				1						
	1143/105					1					
	1143/106						1				
	1143/107							1			
	1143/108								1		
	1143/109									1	
	1143/110										1
DOOR UNIT	1072/19A	1	1	1	1	1	1	1	1	1	1
EXPANSION MODULE	1038/17	1	1	1	1	1	1	1	1	1	1
FLUSH-MOUNTING	1145/52	1	1					2	2		
	1145/53			1	1	1	1			2	2
SPACER	1143/60	1	1	1	1	1	1	2	2	2	2

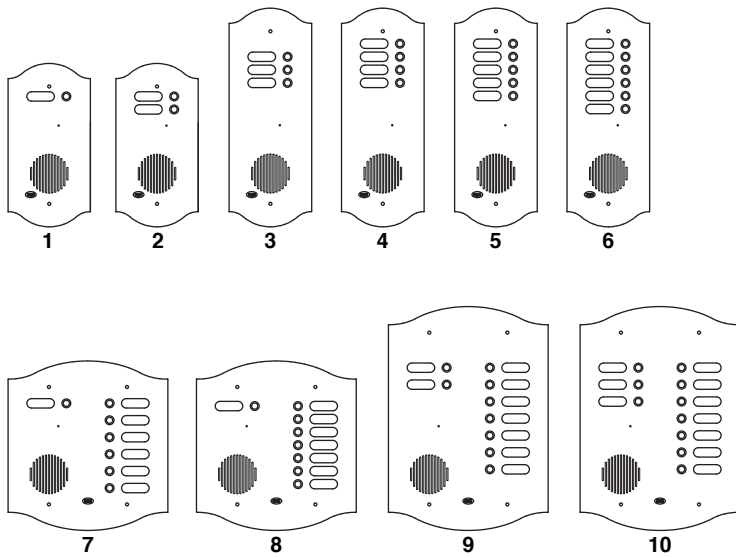



PUSH BUTTON PANEL EXIGO VIDEO DOOR PHONE SYSTEMS IN SINTHESI BOXES



EXAMPLES OF MODULAR CONSTRUCTIONS WITH VARIOUS CAPACITIES

PUSH BUTTON PANEL EXIGO - VIDEO DOOR PHONE SYSTEMS IN SINTHESI BOXES

		BUTTONS NUMBER									
		1	2	3	4	5	6	7	8	9	10
FRONT	1743/101	1									
	1743/102		1								
	1743/103			1							
	1743/104				1						
	1743/105					1					
	1743/106						1				
	1743/107							1			
	1743/108								1		
	1743/109									1	
	1743/110										1
DOOR UNIT	1072/19A	1	1	1	1	1	1	1	1	1	1
EXPANSION MODULE	1038/17	1	1	1	1	1	1	1	1	1	1
TV CAMERA UNIT COLOURS	1810/40	1	1	1	1	1	1	1	1	1	1
ADAPTATION DEVICE	1742/13A	1	1	1	1	1	1	1	1	1	1
FLUSH-MOUNTING	1145/53	1	1					2	2	2	2
	1145/54			1	1	1	1				
SPACER	1143/60	1	1	1	1	1	1	2	2	2	2
		1	2	3	4	5	6	7	8	9	10

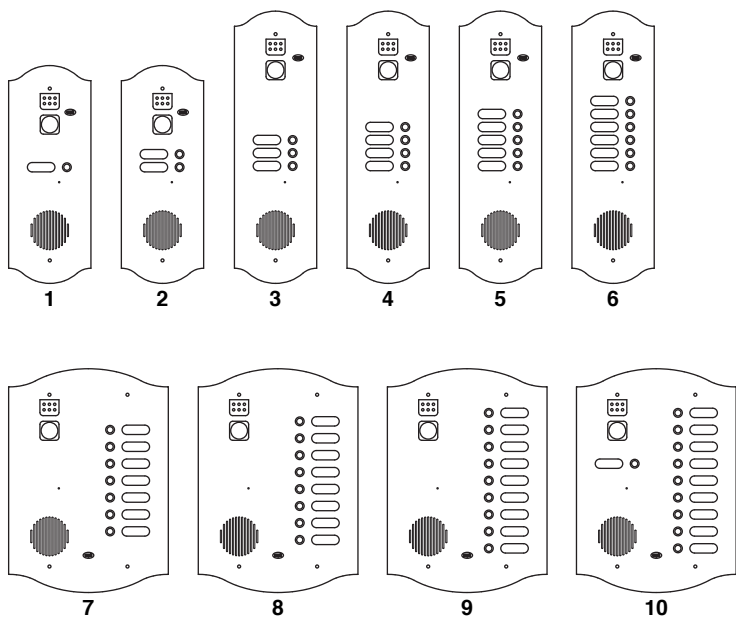

PUSH BUTTON PANELS



EXAMPLES OF MODULAR CONSTRUCTIONS WITH VARIOUS CAPACITIES

		BUTTONS NUMBER																			
		1 row				2 rows															
		3	4	5	6	4	6	8	10	12	14	16	18	20							
FRONT	1121/103	1																			
	1121/104		1																		
	1121/105			1																	
	1121/106				1																
	1121/204					1															
	1121/206						1														
	1121/208							1													
	1121/210								1												
	1121/212									1											
	1121/214										1										
	1121/216											1									
1121/218												1									
1121/220													1								
DOOR UNIT	1072/19A	1	1	1	1	1	1	1	1	1	1	1	1	1	1	1	1	1	1		
EXPANSION MODULE	1038/17	1	1	1	1	1	1	1	1	1	1	1	1	1	2	2					
FLUSH-MOUNTING	1121/53	1																			
	1121/54		1																		
	1121/55			1																	
	1121/56				1																
	1121/60					1	1														
	1121/62							1	1												
	1121/64									1											
	1121/65											1									
	1121/66												1								
	1121/67													1							
1121/68														1							
		3	4	5	6	4	6	8	10	12	14	16	18	20							
		1 row				2 rows															
		BUTTONS NUMBER																			

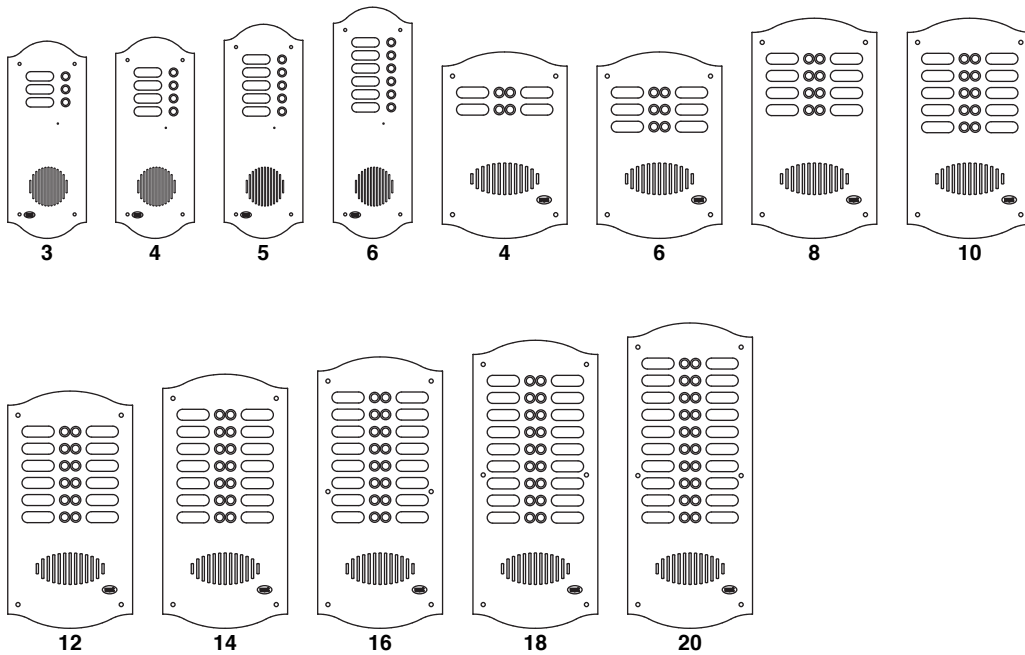



PUSH BUTTON PANEL EXIGO VIDEO DOOR PHONE SYSTEMS IN DEDICATED BOXES



EXAMPLES OF MODULAR CONSTRUCTIONS WITH VARIOUS CAPACITIES

PUSH BUTTON PANEL EXIGO - VIDEO DOOR PHONE SYSTEMS IN DEDICATED BOXES

		BUTTONS NUMBER															
		1 row				2 rows											
		3	4	5	6	4	6	8	10	12	14	16	18	20			
FRONT	1721/103	1															
	1721/104		1														
	1721/105			1													
	1721/106				1												
	1721/204					1											
	1721/206						1										
	1721/208							1									
	1721/210								1								
	1721/212									1							
	1721/214										1						
	1721/216											1					
1721/218												1					
1721/220													1				
DOOR UNIT	1072/19A	1	1	1	1	1	1	1	1	1	1	1	1	1	1	1	
EXPANSION MODULE	1038/17	1	1	1	1	1	1	1	1	1	1	1	1	2	2		
TV CAMERA UNIT COLOURS	1810/40	1	1	1	1	1	1	1	1	1	1	1	1	1	1	1	
ADAPTATION DEVICE	1742/13A	1	1	1	1	1	1	1	1	1	1	1	1	1	1	1	
FLUSH-MOUNTING	1721/53	1															
	1721/54		1														
	1721/55			1													
	1721/56				1												
	1721/60					1											
	1721/61						1										
	1721/62							1									
	1721/63								1								
	1721/64									1							
	1721/65										1						
	1721/66											1					
1721/67												1					
1721/68													1				

(#) alternatives

		BUTTONS NUMBER															
		1 row				2 rows											
		3	4	5	6	4	6	8	10	12	14	16	18	20			

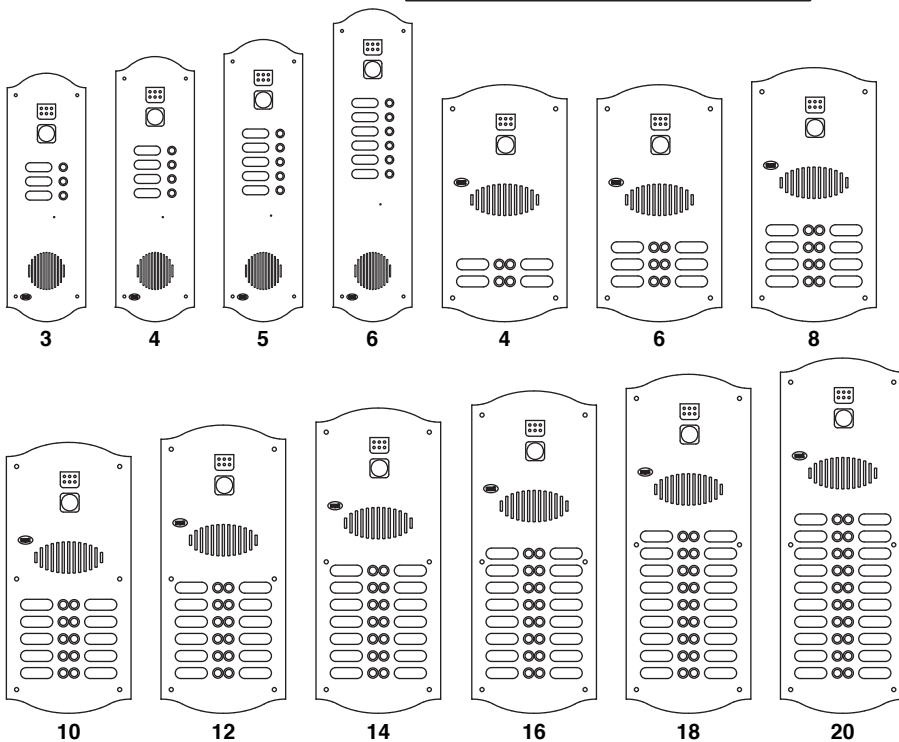

PUSH BUTTON PANELS